

Thursday, August 20, 2020  
10:00 am.



PLACE: ET 6 MR NW 06-127

## SUBDIVISION AUTHORITY MINUTES MEETING NO. 33

**PRESENT** Blair McDowell, Chief Subdivision Officer

**1. ADOPTION OF AGENDA**

MOVED

Blair McDowell

That the Subdivision Authority Agenda for the August 20, 2020 meeting be adopted.

FOR THE MOTION

Blair McDowell

**CARRIED**

**2. ADOPTION OF MINUTES**

MOVED

Blair McDowell

That the Subdivision Authority Minutes for the August 13, 2020 meeting be adopted.

FOR THE MOTION

Blair McDowell

**CARRIED**

**3. OLD BUSINESS**

**4. NEW BUSINESS**

1.

LDA18-0061  
273302578-001

REVISION of conditionally approved tentative plan of subdivision to create six (6) semi-detached residential lots and one (1) multi-unit housing lot (MHL) from Lot 24, Block 10, Plan 162 4358 located east of May Crescent NW and north of Anthony Henday Drive NW; **MAGRATH HEIGHTS**

MOVED

Blair McDowell

That the application for subdivision be Approved.

FOR THE MOTION

Blair McDowell

**CARRIED**

2.

LDA18-0588  
294343213-001

REVISION of conditionally approved tentative plan of subdivision to create 10 row housing lots and one (1) multi-unit housing lot (MHL) from Lot 24, Block 10, Plan 162 4358 located east of May Crescent NW and north of Anthony Henday Drive NW; **MAGRATH HEIGHTS**

MOVED

Blair McDowell

That the application for subdivision be Approved.

FOR THE MOTION

Blair McDowell

**CARRIED**

3.	LDA20-0182 365795940-001	Tentative plan of subdivision to create one (1) additional single detached residential lot from Lot 12, Block 16, Plan 3686HW, located south of Avenue NW and west of 111 Street NW; <b>PARKALLEN</b>	
MOVED		Blair McDowell  That the application for subdivision be Approved.	
FOR THE MOTION		Blair McDowell	<b>CARRIED</b>
5.	<b>ADJOURNMENT</b>  The meeting adjourned at 10:05 a.m.		



August 20, 2020

File No. LDA18-0061

Stantec Consulting Ltd.  
400 - 10220 103 Avenue NW  
Edmonton, AB T5J 0K4

ATTENTION: Elise Shillington

RE: REVISION of conditionally approved tentative plan of subdivision to create six (6) semi-detached residential lots and one (1) multi-unit housing lot (MHL) from Lot 24, Block 10, Plan 162 4358 located east of May Crescent NW and north of Anthony Henday Drive NW; **MAGRATH HEIGHTS**

---

LDA18-0061 was initially approved on May 31, 2018. The first change request removed residential lots and introduced phasing. A second change request removed one (1) MHL to incorporate that lot within LDA18-0588, thereby realigning the subdivision boundaries. This third change request removes 3 row housing lots and replaces them with 2 semi-detached lots for an overall reduction of 1.

**I The Subdivision by Plan is APPROVED on August 20, 2020, subject to the following conditions:**

1. that the owner enter into a Servicing Agreement with the City of Edmonton pursuant to Section 655 of the Municipal Government Act;
2. that the owner prepare the necessary plans and documentation to grant new or carry forward existing easements and restrictive covenants in favour of the City of Edmonton, EPCOR Distribution & Transmission Inc., EPCOR Water Services Inc., and EPCOR Drainage Services, as required by the aforementioned agencies or shown on the engineering drawings that are deemed to be part of the Servicing Agreement;
3. that the owner be permitted to register this plan of subdivision in phases in sequential order, as shown on the "Conditions of Approval" map, Enclosure I;
4. that the owner register a Top of Bank restrictive covenant in favour of the City of Edmonton against the lots backing onto the Top of Bank, as per the applicable development restrictions shown by the Larch Lands Subdivision Geotechnical Investigation report (File No. 19-423-46), as shown on the "Conditions of Approval" map, Enclosure I; and
5. that the owner pay all outstanding property taxes prior to the endorsement of the plan of survey.

**II The Servicing Agreement required in Clause I (1) shall contain, among other things, the following:**

1. that the owner pay all servicing costs, assessments, roadway modification costs (including but not limited to sidewalk, shared use path and/or transit infrastructure), construction costs and inspection costs required by this subdivision;

2. that the owner pay all costs specified in the Servicing Agreement prior to endorsement of the plan of survey;
3. that the owner submits an Erosion and Sediment Control (ESC) Plan specific for this development and for implementation during and after construction in accordance with the City of Edmonton ESC Guidelines and Field Manual;
4. that the owner submits detailed engineering drawings and technical studies in accordance with the City of Edmonton Design and Construction Standards and to the satisfaction of the City Departments and affected utility agencies; and
5. that the owner construct all fences wholly on privately-owned lands, to the satisfaction of Transportation Planning and Engineering and Parkland Developer Services, as shown on the "Conditions of Approval" map, Enclosure I.

Enclosure I is a map of the subdivision identifying major conditions of this approval.

Municipal Reserve for Lot 24, Block 10, Plan 162 4358 was addressed by money in place with LDA16-0232.

Please be advised that the approval is valid for one (1) year from the date on which the subdivision approval is given to the application. An extension beyond that time may be granted by the City of Edmonton.

Please be advised that an appeal may be lodged in accordance to Section 678 of the Municipal Government Act with the Subdivision and Development Appeal Board, 10019 - 103 Avenue NW, Edmonton Alberta, T5J 0G9, within 14 days from the date of the receipt of this decision. The date of receipt of the decision is deemed to be seven (7) days from the date the decision is mailed.

If you have further questions, please contact [subdivisions@edmonton.ca](mailto:subdivisions@edmonton.ca).

Regards,



Blair McDowell  
Subdivision Authority

BM/mb/Posse #273302578-001

Enclosure

SUBDIVISION CONDITIONS OF APPROVAL MAP

August 20, 2020

LDA18-0061

■■■■ Limit of proposed subdivision

\* Restrictive Covenant re: Top Of Bank

----- 1.2 m uniform fence

—— Phasing line

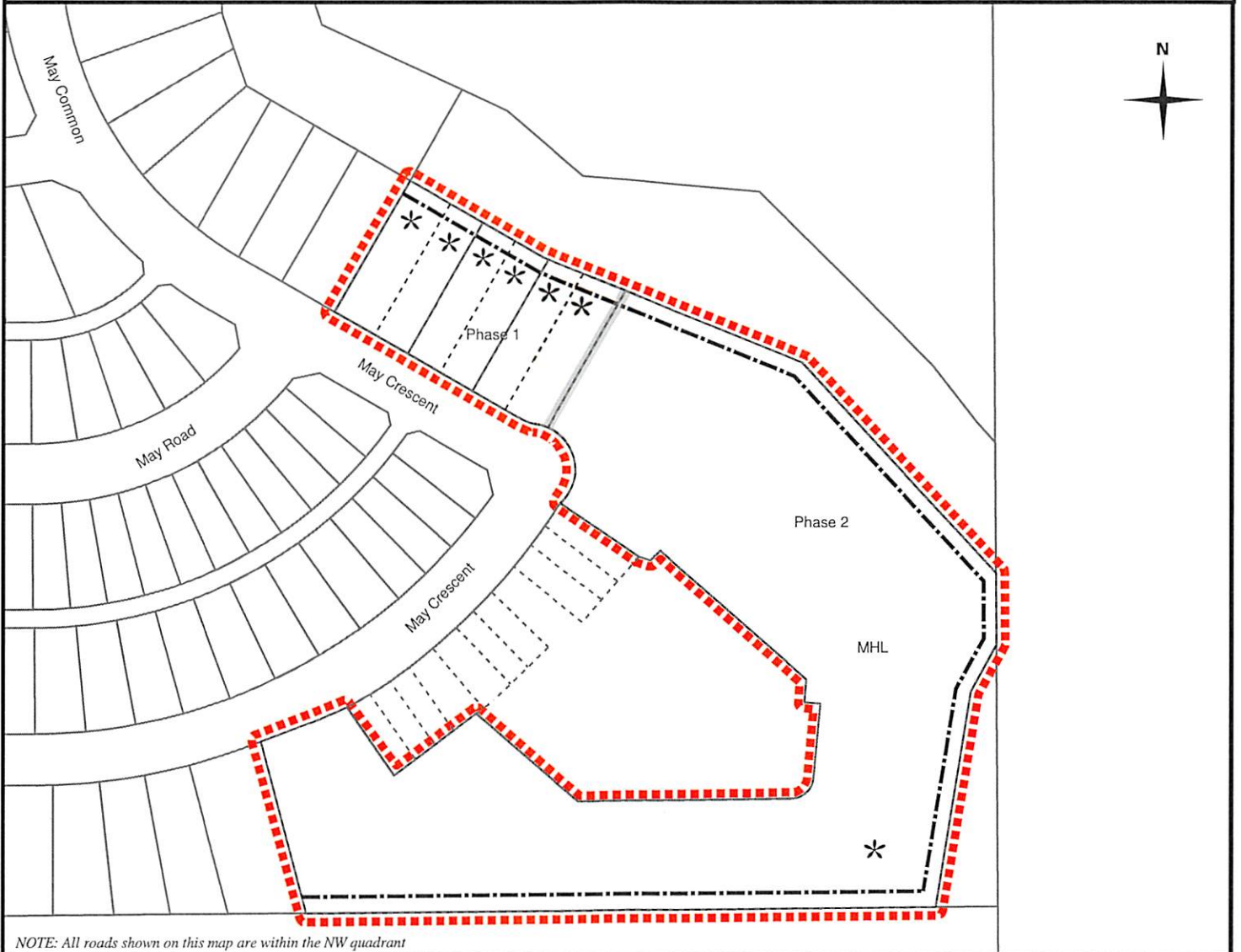

NOTE: All roads shown on this map are within the NW quadrant

■ Titled area to be subdivided

■■■■ Subdivision area

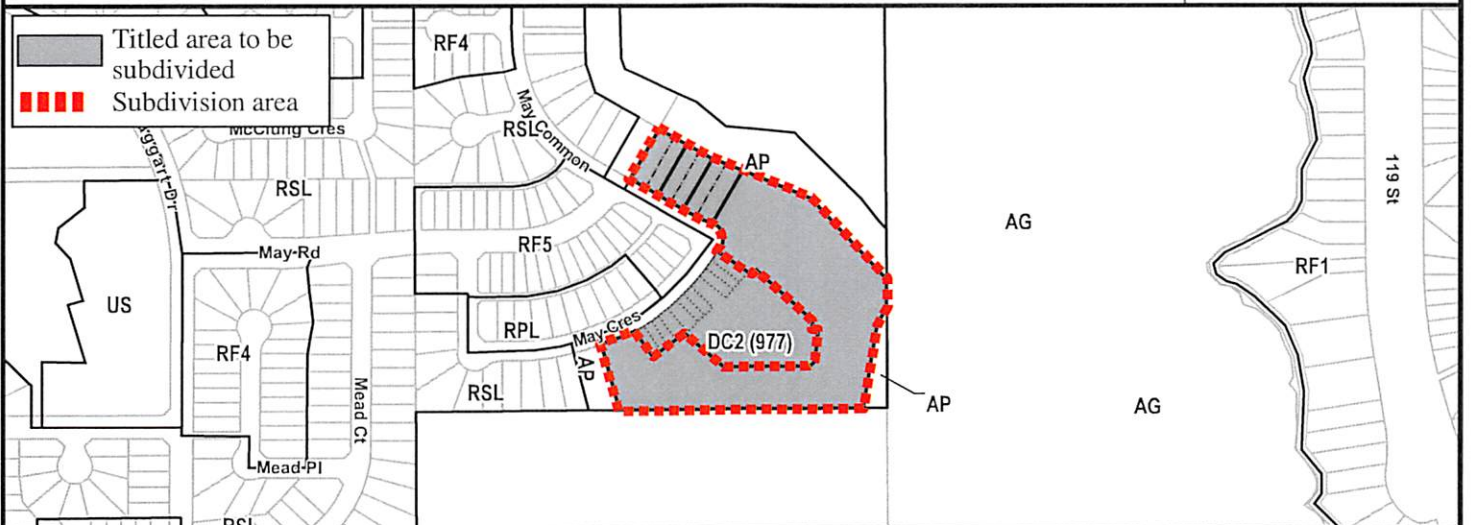





Subdivision Authority

7th Floor, Edmonton Tower  
10111 – 104 Avenue NW  
Edmonton, Alberta T5J 0J4

August 20, 2020

File No. LDA18-0588

Stantec Consulting Ltd.  
400 - 10220 103 Avenue NW  
Edmonton, AB T5J 0K4

ATTENTION: Elise Shillington

RE: REVISION of conditionally approved tentative plan of subdivision to create 10 row housing lots and one (1) multi-unit housing lot (MHL) from Lot 24, Block 10, Plan 162 4358 located east of May Crescent NW and north of Anthony Henday Drive NW; **MAGRATH HEIGHTS**

---

The application revises the lot dimensions of the original subdivision that was approved on January 30, 2020.

**I The Subdivision by Plan is APPROVED on August 20, 2020, subject to the following conditions:**

1. that the owner enter into a Servicing Agreement with the City of Edmonton pursuant to Section 655 of the Municipal Government Act;
2. that the owner prepare the necessary plans and documentation to grant new or carry forward existing easements and restrictive covenants in favour of the City of Edmonton, EPCOR Distribution & Transmission Inc., EPCOR Water Services Inc., and EPCOR Drainage Services, as required by the aforementioned agencies or shown on the engineering drawings that are deemed to be part of the Servicing Agreement;
3. that the owner be permitted to register this plan of subdivision in phases in sequential order, as shown on the "Conditions of Approval" map, Enclosure I; and
4. that the owner pay all outstanding property taxes prior to the endorsement of the plan of survey.

**II The Servicing Agreement required in Clause I (1) shall contain, among other things, the following:**

1. that the owner pay all servicing costs, assessments, roadway modification costs (including but not limited to sidewalk, shared use path and/or transit infrastructure), construction costs and inspection costs required by this subdivision;
2. that the owner pay all costs specified in the Servicing Agreement prior to endorsement of the plan of survey;
3. that the owner submits an Erosion and Sediment Control (ESC) Plan specific for this development and for implementation during and after construction in accordance with the City of Edmonton ESC Guidelines and Field Manual; and

4. that the owner submits detailed engineering drawings and technical studies in accordance with the City of Edmonton Design and Construction Standards and to the satisfaction of the City Departments and affected utility agencies.

Enclosure I is a map of the subdivision identifying major conditions of this approval.

Municipal Reserve for Lot 24, Block 10, Plan 162 4358 was addressed by money in place with LDA16-0232.

Please be advised that the approval is valid for one (1) year from the date on which the subdivision approval is given to the application. An extension beyond that time may be granted by the City of Edmonton.

Please be advised that an appeal may be lodged in accordance to Section 678 of the Municipal Government Act with the Subdivision and Development Appeal Board, 10019 - 103 Avenue NW, Edmonton Alberta, T5J 0G9, within 14 days from the date of the receipt of this decision. The date of receipt of the decision is deemed to be seven (7) days from the date the decision is mailed.

If you have further questions, please contact [subdivisions@edmonton.ca](mailto:subdivisions@edmonton.ca).

Regards,



Blair McDowell  
Subdivision Authority

BM/mb/Posse #294343213-001

Enclosure

SUBDIVISION CONDITIONS OF APPROVAL MAP

August 20, 2020

LDA18-0588

- Limit of proposed subdivision
- Phasing line

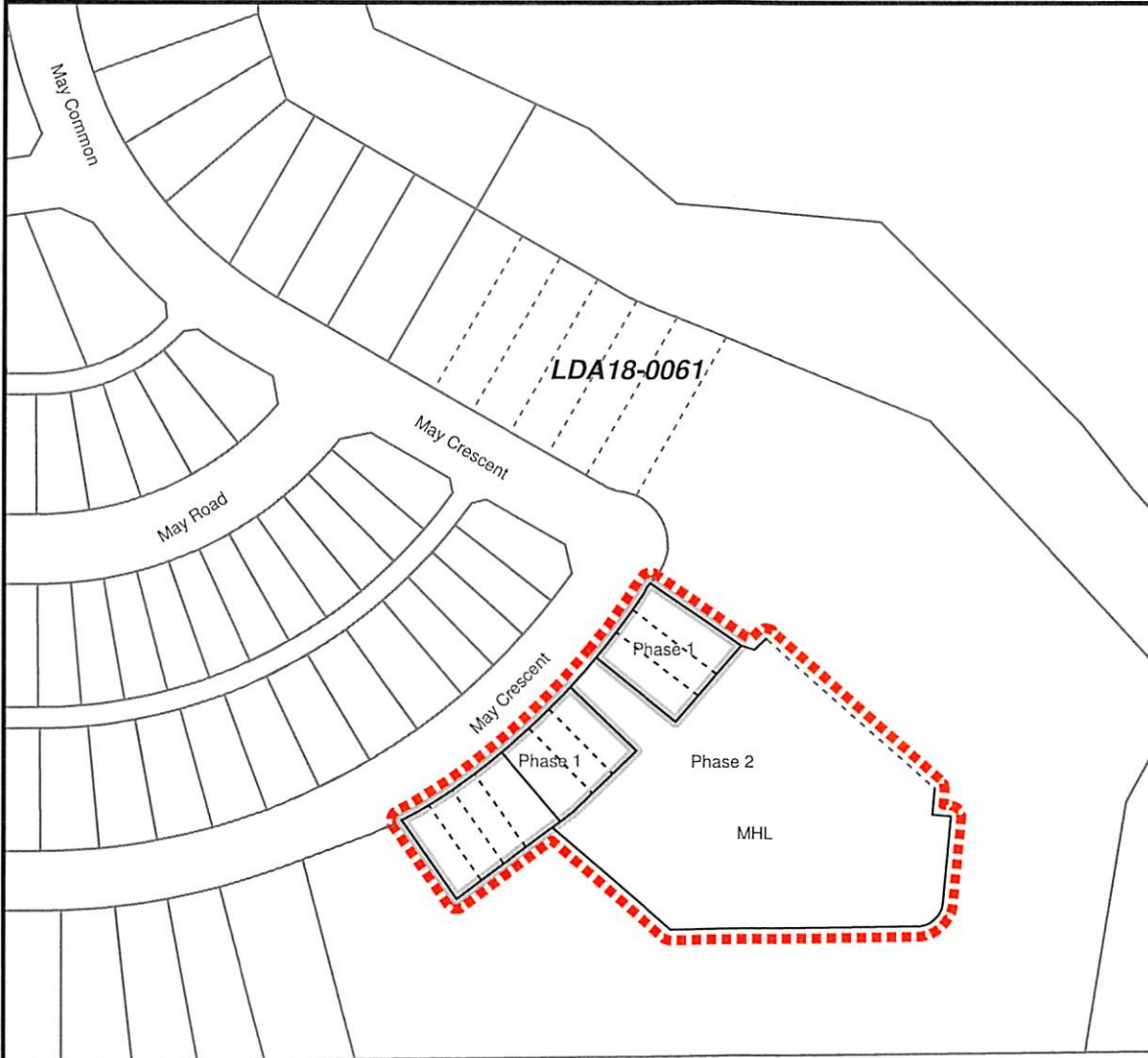

NOTE: All roads shown on this map are within the NW quadrant

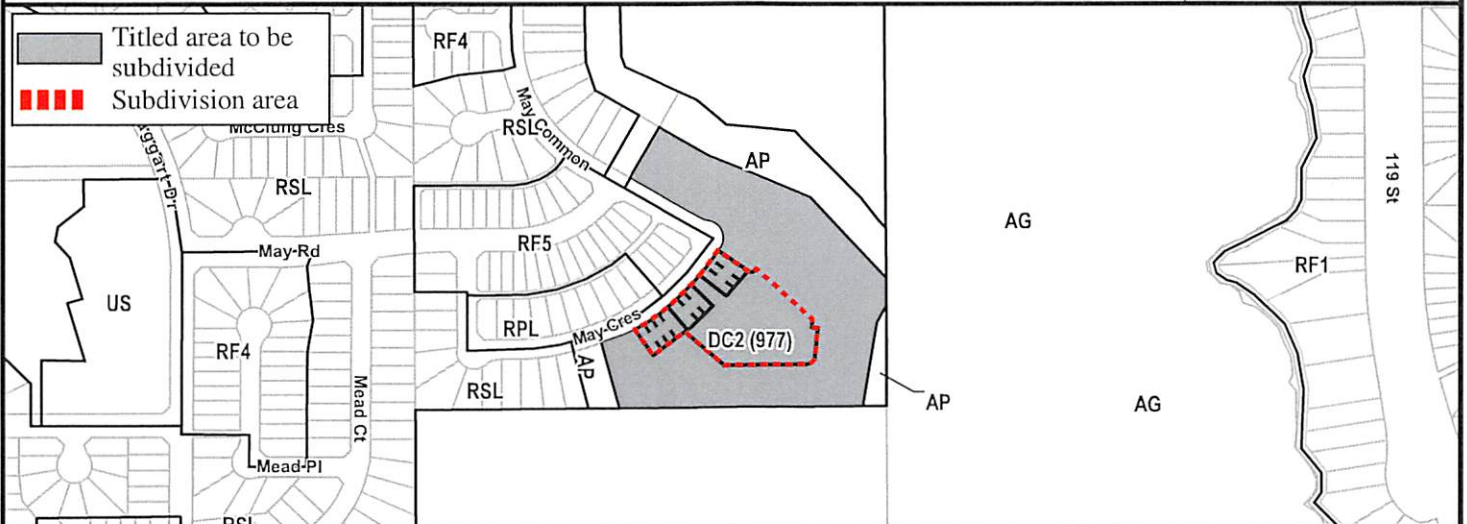





Subdivision Authority

7th Floor, Edmonton Tower  
10111 – 104 Avenue NW  
Edmonton, Alberta T5J 0J4

August 20, 2020

File No. LDA20-0182

Hagen Surveys (1982) Ltd.  
8929 - 20 Street NW  
Edmonton, AB T6P 1K8

ATTENTION: Glendon Chen

RE: Tentative plan of subdivision to create one (1) additional single detached residential lot from Lot 12, Block 16, Plan 3686HW, located south of Avenue NW and west of 111 Street NW; **PARKALLEN**

---

**The Subdivision by Plan is APPROVED on August 20, 2020, subject to the following conditions:**

1. that the owner apply for a permit to demolish the existing dwelling and garage prior to endorsement of the final plan. Demolition permits can be obtained from Development Services located on the 2nd floor of Edmonton Tower at 10111 - 104 Avenue NW;
2. that the final plan of survey shall conform to the attached revised tentative plan; and
3. that the owner pay all outstanding property taxes prior to the endorsement of the plan of survey.

Enclosure I is an attachment of the major advisements throughout the subdivision process. Enclosure II is a map of the subdivision and identifies major conditions and advisements of this approval.

Please be advised that the approval is valid for one (1) year from the date on which the subdivision approval is given to the application. An extension beyond that time may be granted by the City of Edmonton.

Please be advised that an appeal may be lodged in accordance to Section 678 of the Municipal Government Act with the Subdivision and Development Appeal Board, 10019 - 103 Avenue NW, Edmonton Alberta, T5J 0G9, within 14 days from the date of the receipt of this decision. The date of receipt of the decision is deemed to be seven (7) days from the date the decision is mailed.

The Subdivision Authority did not receive comments from adjacent landowners. The application complies with the regulations set out in the Edmonton Zoning Bylaw, the land is serviceable, and the proposal advances a more compact urban form. The Subdivision Authority is of the opinion, after considering factors set out in Section 7 of the Subdivision and Development Regulation, that the land is suitable for the purpose for which the subdivision is intended.

If you have further questions, please contact [subdivisions@edmonton.ca](mailto:subdivisions@edmonton.ca).

Regards,



Blair McDowell  
Subdivision Authority

BM/mb/Posse #365795940-001

Enclosures

Please be advised of the following:

Next Steps for Subdivision Approval

- The next step in the subdivision process is to have a legal instrument prepared (ie. Plan of Survey) in order to register the approved subdivision. The legal instrument is then forwarded to the City for endorsement along with the endorsement fee (\$686.00 - 2020 Fees Schedule) and subsequently released to the applicant for registration at the Land Titles Office.

Transportation

- There are existing boulevard trees adjacent to the site on 71 Avenue NW that must be protected during construction. For information about tree protection please refer to the City of Edmonton's website (Trees and Construction).
- Access for future development must be to the adjacent alley in conformance with Mature Neighbourhood Overlay Section 814.3(17) of the Zoning Bylaw #12800.
- There are existing concrete stairs that encroach onto the 71 Avenue road right-of-way that must be removed with future redevelopment of the site. Permanent objects are not permitted to encroach within road right-of-way without entering into an Encroachment Agreement with the City of Edmonton.

Building / Site

- The owner shall ensure that any change in property boundaries does not cause any structures on site to become non-compliant with the Safety Codes Act and the Alberta Building Code. Permits may be required for such changes. Please contact 311 for more information.

Servicing

- The owner is required to make satisfactory arrangements for, and pay all costs associated with separate servicing to each lot, as well as the modification, relocation and/or removal of existing services. For further information, please contact: EPCOR Distribution & Transmission Inc. (780-412-4000), TELUS Communications (Edmonton) Inc. (Real Estate Division [Rights of Way] 780-508-2456), ATCO Gas (780-424-5222), and EPCOR Drainage Services (Water and Sewer Servicing 780-496-5444).
- The existing services (water and sanitary) enter the proposed subdivision approximately 7.4 m east of the west property line of Lot 12 off 71 Avenue NW. As per the EPCOR Drainage Services Bylaw and the EPCOR Water Services and Wastewater Treatment Bylaw, these services cannot cross the proposed property line.
- The applicant, Hagen Surveys (1982) Ltd., visited the property and located the services within the Avenue. They are confirmed at 7.24 metres east of the west property line.
- There is a deficiency in on-street hydrant spacing adjacent to the property. The applicant/owner is advised to review on-site fire protection requirements to ensure adequate coverage (contact EPCOR Water at 780-412-3955).
- If power service crosses the proposed property line the owner may be required to provide a blanket easement in favour of EPCOR Distribution & Transmission Inc. If required, said easement shall be registered prior to or concurrent with the final plan of survey (contact EPCOR Land Administration Group at 780-412-3252).

# TENTATIVE PLAN

SHOWING SUBDIVISION OF

LOT 12, BLOCK 16, PLAN 3686 H.W.

WITHIN

N.E.1/4 SEC.19-52-24-4

EDMONTON ALBERTA

SCALE 1:200 2020 D.G.CHEN, A.L.S.



NOTE:  
 - DISTANCES ARE APPROXIMATE AND ARE IN METRES AND DECIMALS THEREOF.  
 - AREA DEALT WITH BOUNDED THUS. ——— AND CONTAINS 0.10 ha.

HAGEN SURVEYS (1982) LTD.

8929-20 STREET, EDMONTON. Ph: 464-5506

SURVEYOR'S STAMP



DRAWN BY: J.H.

CALC'D. BY: —

DATE: JUNE 19, 2020  
 REVISED: Aug. 12, 2020

FILE NO. 20S0206

DWG.NO. 20S0206T

LOT 13  
 PLAN 2503 H.W.

