

Corridor & Access Plan - Area 5B

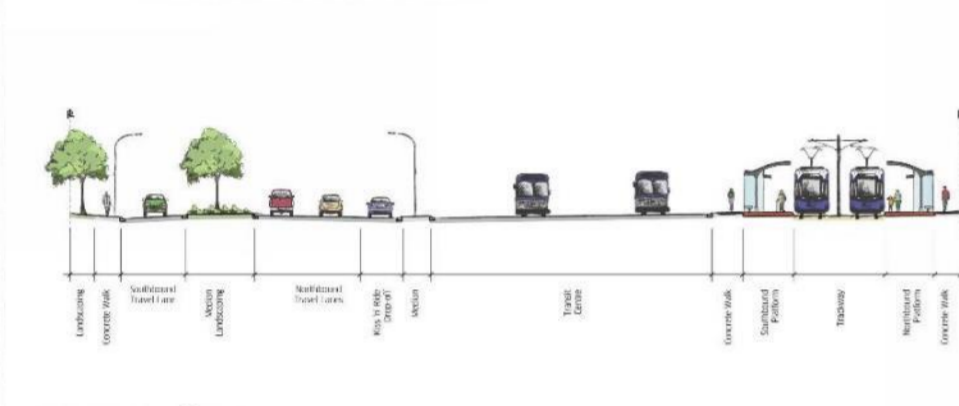

156 Street Stop

Notes: Design coordinated with Stony Plain Road Streetscape Initiative. Layout of Transit Centre and Transit Oriented Development subject to a separate planning exercise. 156 Street Stop is currently under review.



Theme: "Park-Like"

Existing Conditions

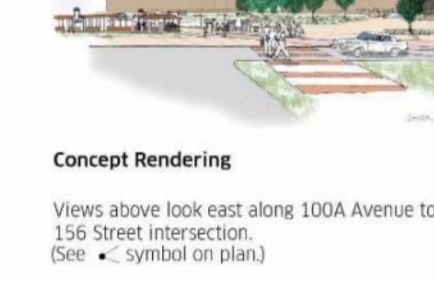

Stop Images View 11

149 Street Stop

Notes: Design coordinated with Stony Plain Road Streetscape Initiative.

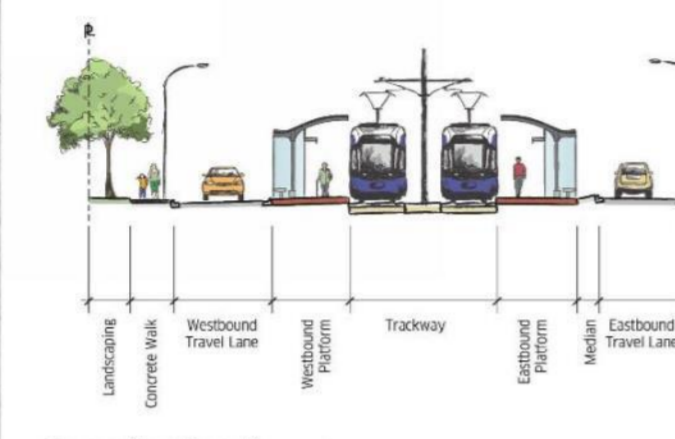

Theme: "Park-Like"

Existing Conditions

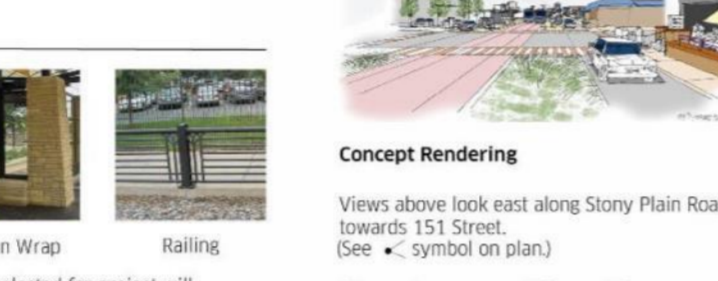

Stop Images View 10

142 Street Stop

Theme: "Park-Like"



Stop Images View 9

Glenora Stop

Theme: "Historic"

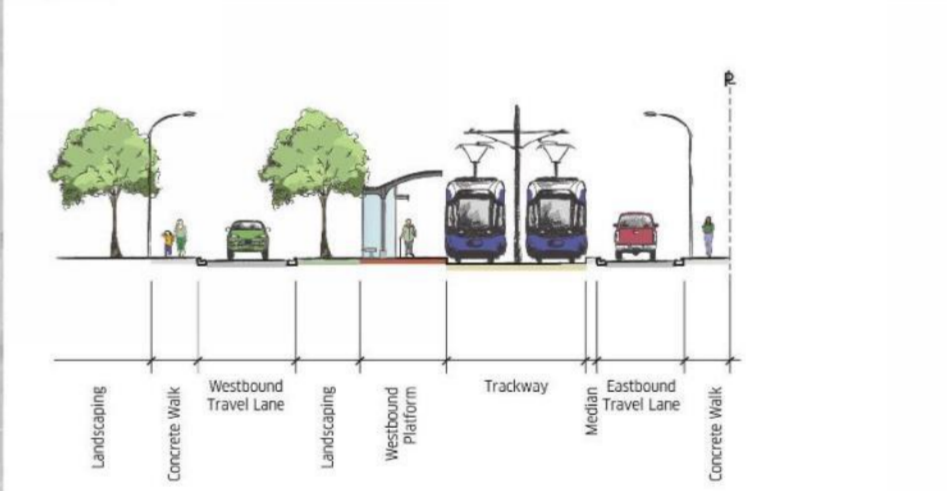

Stop Images View 8

Bridge Over Groat Road

- Existing Groat Road Bridge is not wide enough to accommodate the addition of the LRT.
- Existing bridge to be demolished and replaced with a new bridge: Stony Plain Road between 129 Street and Connaught Drive to be closed during construction.
- New bridge will include improved pedestrian connections.
- Recommended Bridge Option: Single Span Haunched Steel Girder.
- Preliminary design is ongoing.



Bridge Option Images View 7

General Note: Specific site evaluation must be completed prior to final location and quantity of proposed Bike Parking and Tree Planting.

Ongoing Design Coordinated with the Stony Plain Road Streetscape

Layout of Transit Centre subject to a separate, ongoing planning exercise by City of Edmonton

Note: All bus stop locations and bus routes are being reviewed by ETS to provide an integrated bus/LRT transit system.

| Legend | |
|--------|--|
| | |
| | |
| | |
| | |
| | |
| | |
| | |
| | |

