



Bike Racks
Consistent with Jasper Avenue New Vision to provide visual continuity and simplify maintenance and/or replacement in the future.

Wood Benches on Granite or Concrete Upstands

Ipe wood timbers and granite or concrete upstands provide visual continuity with Jasper Avenue New Vision, while allowing for opportunities to create a variety of seating types that are visually consistent.



Roadway and Pedestrian Lighting

Luminaires will be consistent with Jasper Avenue New Vision, mounted on simple straight poles, with both roadway and pedestrian lighting.

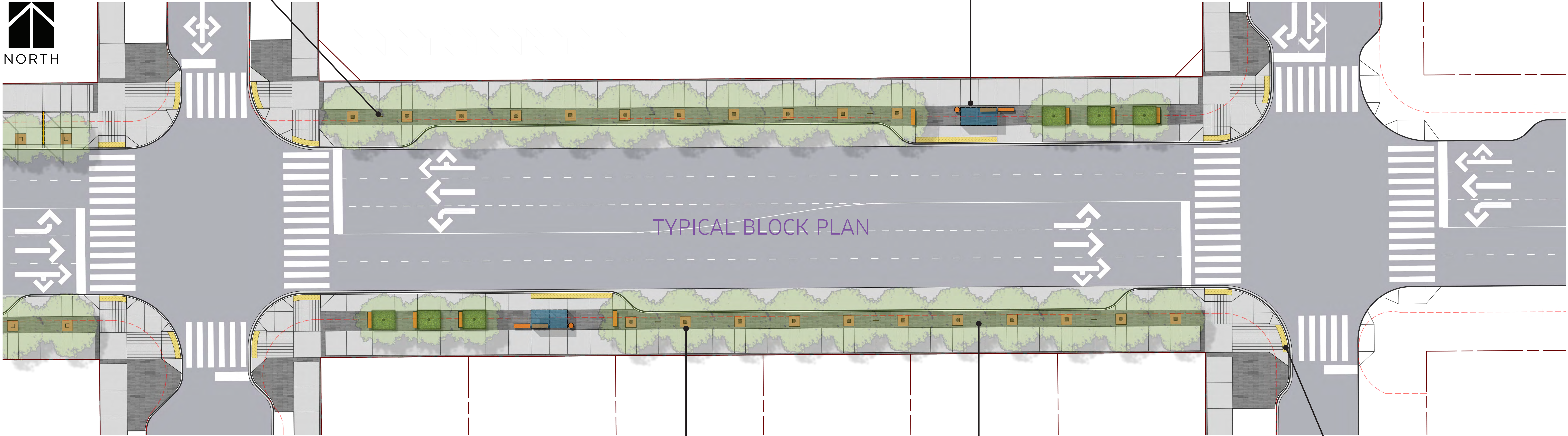

Waste Receptacles
Consistent with Jasper Avenue New Vision, with top access, to provide visual continuity and simplify maintenance and/or replacement in the future.



Tree Grates
Contemporary grate conforms to accessibility guidelines. Used in other locations in Edmonton which simplifies maintenance and/or replacement in the future.



High-Contrast Furnishing Zone Surface
Contrasting colour of paving in furnishing zone improves wayfinding and clarity for the visually impaired. Intent it to use dark colour concrete paving stones, similar to Jasper Avenue New Vision.



Tactile Walking Surface Indicators
Used at bus stops and intersections to improve safety for the visually impaired.