

Site Plan Standard - Child Care Facility

Standard applies to both development permit (zoning approval) and building permit applications.
Standards apply to business owners working without a contractor. Professionals must adhere to industry drawing standards.

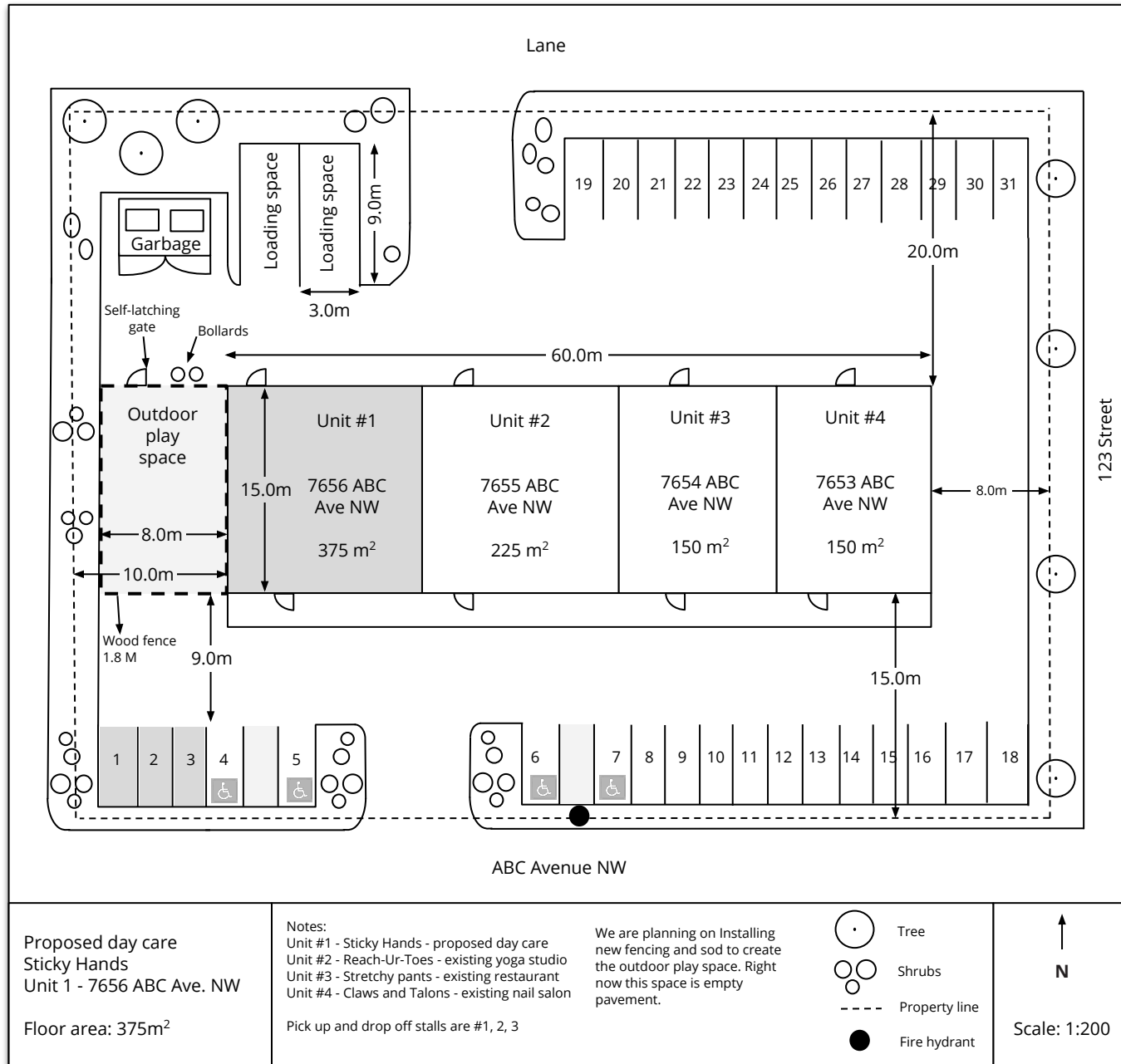

Drawings must contain all items in the checklist. Submitting incomplete drawings will delay application processing.

- Drawing Instructions**
- Metres or feet/inches are accepted. Please use units consistently.
 - Diagrams must be drawn to scale. Minimum scale is 1:500. Tip: Use graph paper to draw to scale.
 - Clearly mark proposed changes to the existing site.

- Site Plan Checklist**
- Information bar:
- Type of business and business name
 - Address including suite number
 - Floor area inside the business
 - North arrow and scale indicator

- Site details:
- Streets, avenues and lanes
 - All property lines
 - Distance from building to all property lines
 - Building measurements
 - Location and dimensions of loading spaces
 - Location of garbage enclosure
 - Location of entrance and exit points
 - Location and number of parking spots
 - Identify accessibility parking
 - Location of nearest fire hydrant

- Details for proposed and existing businesses:
- Type of business(es) and business name(s)
 - Address(es) including suite number
 - Floor area(s) inside the business(es)

- Child care details:
- Outdoor play space and dimensions
 - Fence location, height and material
 - Safety features (self-latching gate, bollards)
 - Location and number of pick-up/drop-off spaces

Checklists identify the minimum information required for application review. More information may be requested during application review.

Proposed day care
Sticky Hands
Unit 1 - 7656 ABC Ave. NW
Floor area: 375m²

Notes:
Unit #1 - Sticky Hands - proposed day care
Unit #2 - Reach-Ur-Toes - existing yoga studio
Unit #3 - Stretchy pants - existing restaurant
Unit #4 - Claws and Talons - existing nail salon
Pick up and drop off stalls are #1, 2, 3

We are planning on installing new fencing and sod to create the outdoor play space. Right now this space is empty pavement.

