



LEWIS FARMS FACILITY & PARK

WHAT WE
HEARD

**SETTING THE DIRECTION
COMMUNITY ENGAGEMENT**

Edmonton

WHAT WE HEARD

YOUR IDEAS,
YOUR VISION,
YOUR DIRECTION...
IN ACTION!

WHAT IS THE LEWIS FARMS FACILITY & PARK?



RECREATION CENTRE



PUBLIC LIBRARY



HIGH SCHOOL ACADEMIC CENTRE



DISTRIC PARK

DESIGN

Our design process has taken place in three phases in 2015 – 17



(APRIL – JULY 2015)

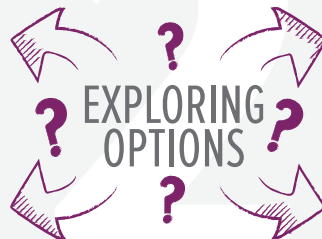

(MAY – JUNE 2016)



(OCTOBER – JANUARY 2017)

SUMMARY

IN LATE 2014, City Council approved funding for the schematic design of the Lewis Farms Facility and Park. This consultation builds upon the two Council approved plans for the Facility and Park: 2007 Council approved Medium Term Recreation Facility and Sports Field Plan and the 2011 Functional Program (high level plan).

In early 2016, the City retained the services of an architectural team (Saucier and Perrotte and Architecture|TKalcic Bengert) who led a design team to develop the facility concept. In addition to the architectural team, the design team includes representatives from Edmonton Public Library, Edmonton Catholic Schools, and several representatives from the City itself (architects, facility planners, facility operators, recreational programmers, and others).

During May to June 2016, we presented facility and park design concepts (developed by the design team) to gather comments from the community, potential users, and stakeholders. The facility and site concepts were developed based upon the program created from the Sharing Ideas consultation.

Based on the engagement findings, application of City standards, and architectural analysis, the facility and site concepts were refined to form a draft schematic design for the facility and the overall site. Those revised draft schematic designs were shared in this latest Setting the Direction consultation. Participants were asked about their satisfaction with the design and whether they felt the design meets the needs of the community. They were also asked about their preference between a 53m pool and green space. The findings from the consultation were used to finalize the schematic design for the facility and park.

ENGAGEMENT PARTICIPATION



OCT. 4, 2016

WEST END
CHRISTIAN ASSEMBLY

180
OPEN
HOUSE
PARTICIPANTS



219
ONLINE
SURVEY
RESPONSES

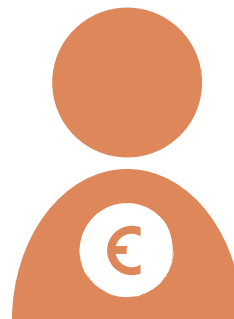

23
CITY STAFF
RESPONSES

WE USED THE FOLLOWING TOOLS TO GET THE WORD OUT ABOUT THE SETTING THE DIRECTION CONSULTATION SESSION.

HOW WE COMMUNICATED

UNADDRESSED MAIL PIECES 

LIKES ON  

WEB HITS 

EVENT RETWEETS  **TWITTER POSTS**

EMAIL INVITES THROUGH CONSULTATION WORK 

ROAD SIGNS 

311 SCRIPT 

CITY OF EDMONTON EVENTS  **CALENDAR POSTINGS**

EDMONTON EXAMINER 

ADS BASED ON ZONE 

COMMITTEE MEETINGS 

This report includes a description of the consultation activities that made up the Setting the Direction consultation phase. It includes how we communicated with the public and stakeholders, who participated, and how they participated. The timeline below illustrates where these activities fit in the process.

Also included is an analysis of the results from the Setting the Direction engagement which was used to finalize the schematic design for the facility and park. A separate document of [What You Said](#) can be found on our website which details all the feedback received from the public and stakeholders for the Setting the Direction consultation.

The decisions made with regards to the facility and site concepts are presented on page 8. Finally, the final schematic designs reflecting your feedback and the decisions that were made are presented on pages 18 – 23.

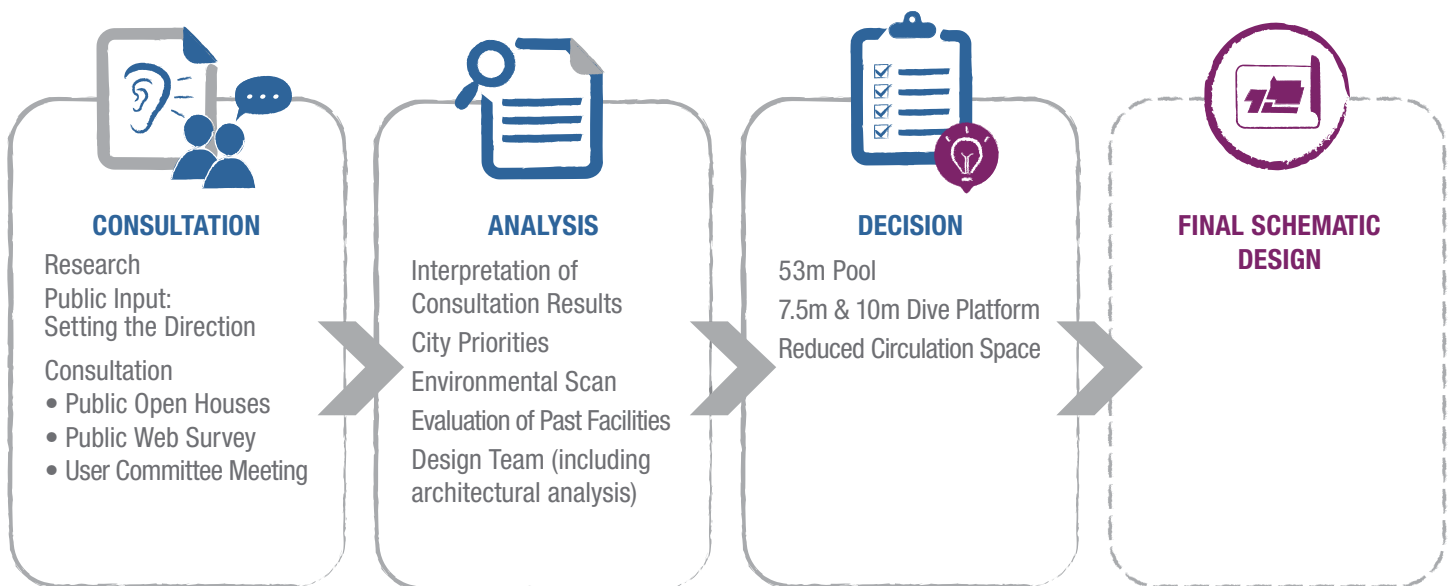

The draft schematic design was developed based on the feedback and analysis during the Exploring Options engagement. The draft schematic design was presented to the public and stakeholders through the Setting the Direction engagement. Feedback was gathered about the facility and site designs, if you thought the City should spend \$8M on the larger pool, and if the planned flexible greenspace should be kept on the park site.

Based on the feedback gathered, along with the City priorities, trends and best practices, an evaluation of past facilities, and site analysis, revisions were made to the draft so we could create the final schematic design. The feedback in this report explains how we ended up with the final schematic design.

SETTING THE DIRECTION PROJECT TIMELINE

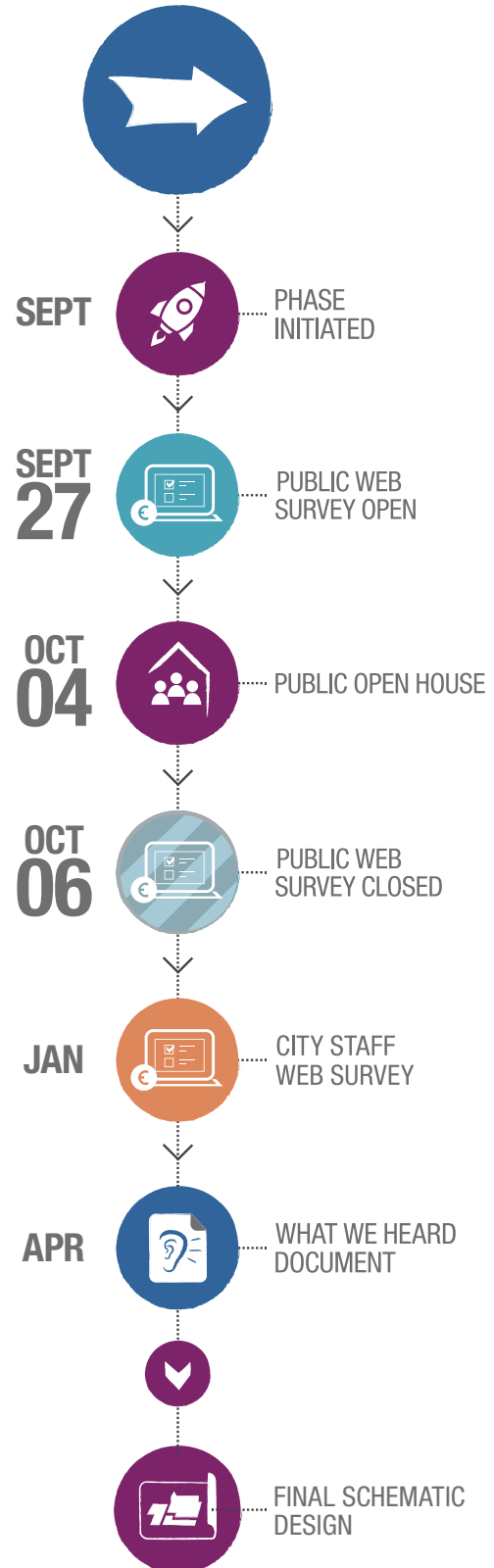

OUR APPROACH

The **SETTING THE DIRECTION** consultation focused on hearing directly from citizens and future users of the facility as they reviewed and provided comment on draft schematic designs for the Lewis Farms Facility and Park.

Based on the facility and site designs presented, comments were sought regarding people's satisfaction with the designs as well as their agreement that the designs meet the needs of the community. Opinions about the preference between a 53m pool and green space were also solicited.



Gathered Your Input



PUBLIC OPEN HOUSE: 180 PARTICIPANTS

Community Services hosted an Open House on October 4, 2016 at the West End Christian Assembly. Those who could not attend the Open House were invited to fill out the online survey.

PUBLIC ONLINE SURVEY: 219 RESPONDENTS

Accessed through www.edmonton.ca/lewisfarmsfacilityandpark

A survey link was also posted on our web site. Survey respondents were notified to fill out this survey through our consultation network (i.e. user committees, community leagues, etc.) by email and Canada Post admail notifications.

CITY STAFF ONLINE SURVEY: 23 RESPONDENTS

An online survey was fielded with City Staff.

HOW YOU PARTICIPATED

YOUR FEEDBACK

FACILITY CONCEPT FEEDBACK

The following draft facility schematic design was presented throughout the engagement activities. The design shows the spaces included in the facility and well as how they are arranged. We asked you about your satisfaction with the draft schematic design and if you felt that the design meets the needs of the community.

DRAFT FACILITY SCHEMATIC DESIGN: GROUND LEVEL

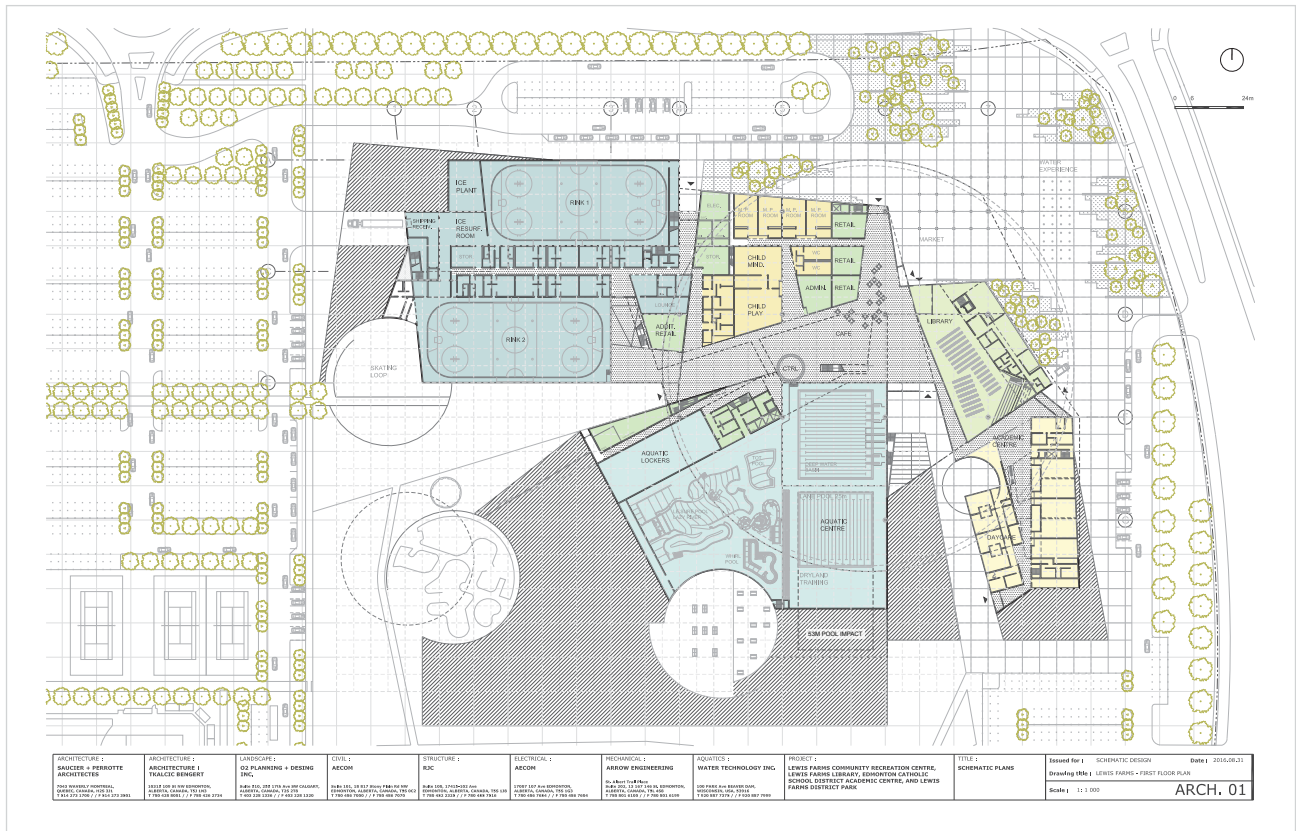

DRAFT FACILITY SCHEMATIC DESIGN: SECOND LEVEL

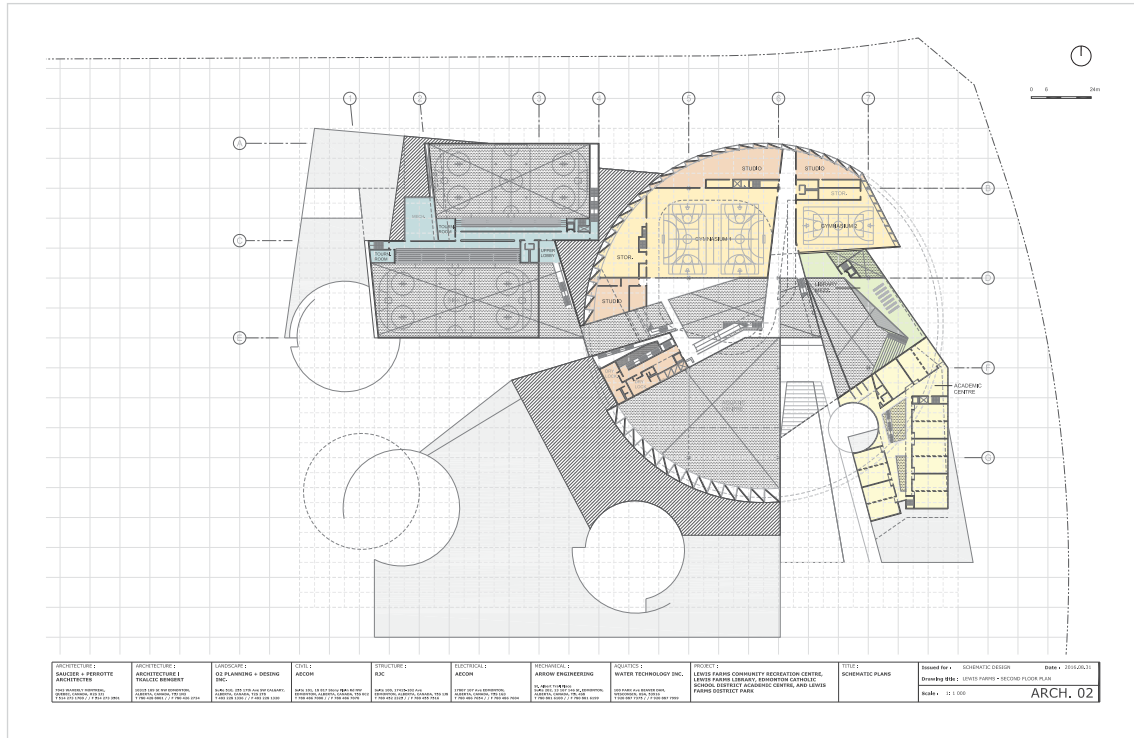

DRAFT FACILITY SCHEMATIC DESIGN: THIRD LEVEL

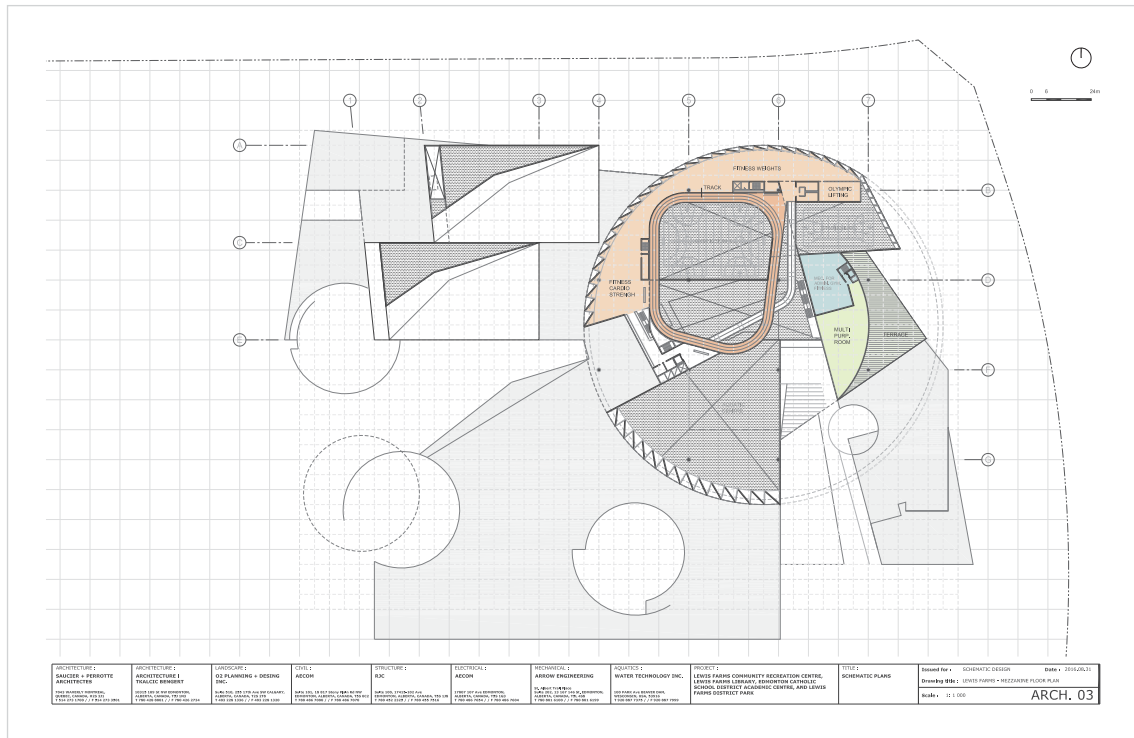

SATISFACTION FEEDBACK

We asked you to think about how you would use the facility and tell us how satisfied you were with the draft schematic design.

LEVEL OF SATISFACTION WITH DRAFT FACILITY SCHEMATIC DESIGN

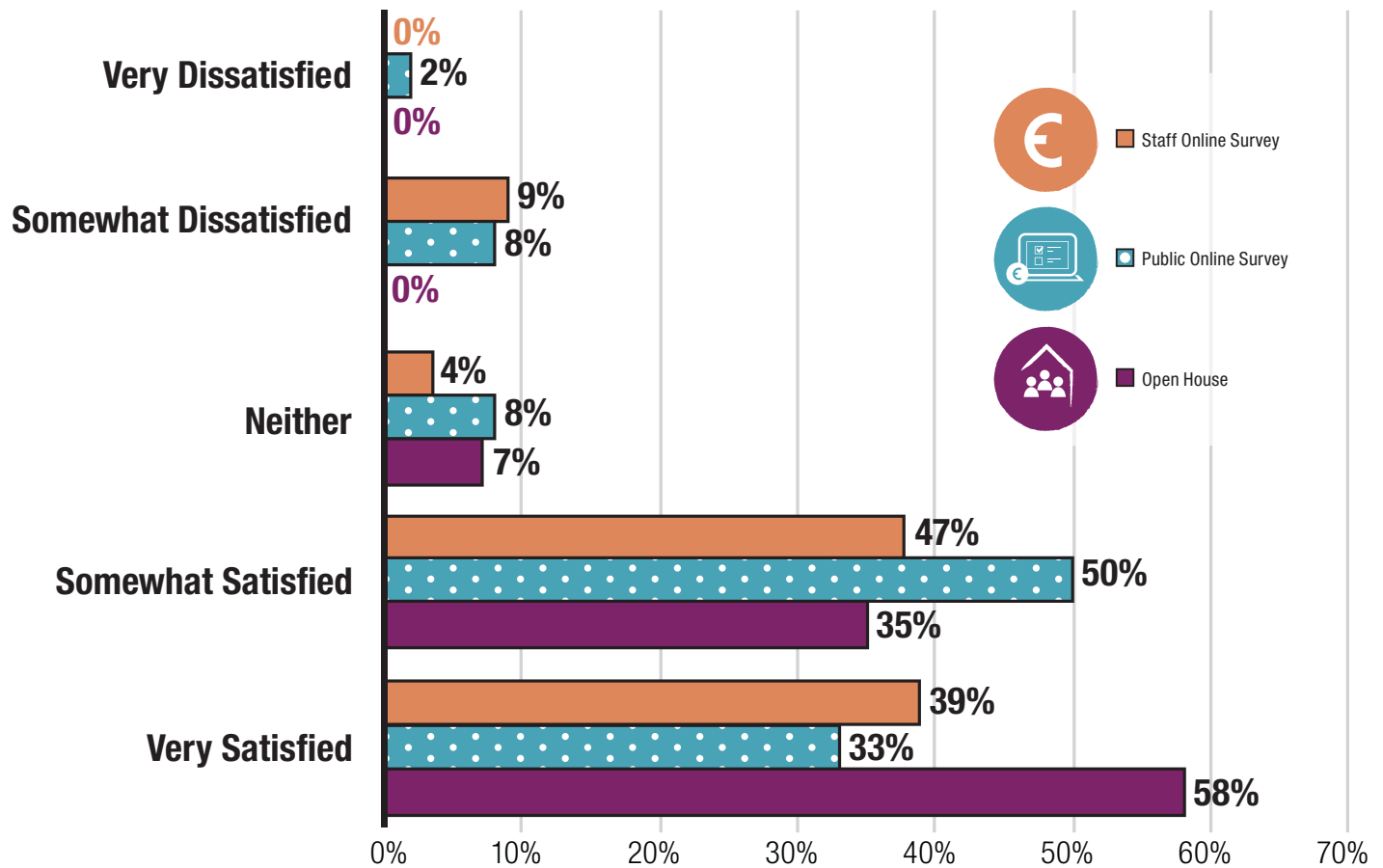

WHAT ARE THE TAKE-AWAYS?

- There is a high level of satisfaction with the draft facility schematic design.
- It was suggested that the 53m pool be included in the facility.
- The grouping of the fitness centre on one level is considered good.
- The schematic design meets the needs of the community.

SUMMARY OF FEEDBACK

You provided comments about the draft facility schematic design. These comments were compiled with the primary thoughts presented as follows.



PUBLIC OPEN HOUSE

SATISFIED

- The facility should include the 53m pool.
- The design is good and includes the necessary activity areas.
- The design is efficient and has lessened the amount of wasted space.
- Gathering the fitness spaces on one level is good.

NEITHER SATISFIED OR DISSATISFIED

- Traffic planning is needed to ensure the area roads can accommodate the increase in traffic due to the facility.
- The parking layout needs improvement. Entrances are far from parking.

DISSATISFIED

- The current fitness space is insufficient and should be larger.
- Additional parking is needed and should be closer to entrances.
- The larger pool is not a community amenity—the smaller pool is good.

PUBLIC ONLINE SURVEY



PUBLIC ONLINE SURVEY

SATISFIED

- The new facility needs to include the 53m pool.
- This facility supports community need—everything is included. There is anticipation for the opening of the facility.
- The facility looks well thought out and very functional.
- Including the 53m pool will lessen the demand on the Kinsmen Aquatic Centre.
- The grouping of the fitness area is good design. Having the fitness and track on the third level is good.

NEITHER SATISFIED OR DISSATISFIED

- A 53m pool is needed in the facility.

DISSATISFIED

- The facility needs the 53m pool.
- The design has too much wasted space. There is too much emphasis on the design.

CITY STAFF ONLINE SURVEY



CITY STAFF ONLINE SURVEY

SATISFIED

- Meets overall objectives and incorporated a lot of feedback.
- Flow and layout look good.
- The option of gender specific and universal change rooms is good.

NEITHER SATISFIED OR DISSATISFIED

- Main floor multipurpose rooms should be convertible into one large space or several smaller spaces.

DISSATISFIED

- The gym on the second floor could be noisy beneath it and cause supervision problems.
- Pool storage seems lacking.

COMMUNITY NEED

We asked you to what extent do you agree that the facility design meets the needs of the community.

LEVEL OF AGREEMENT THAT THE DRAFT FACILITY SCHEMATIC DESIGN MEETS COMMUNITY NEED

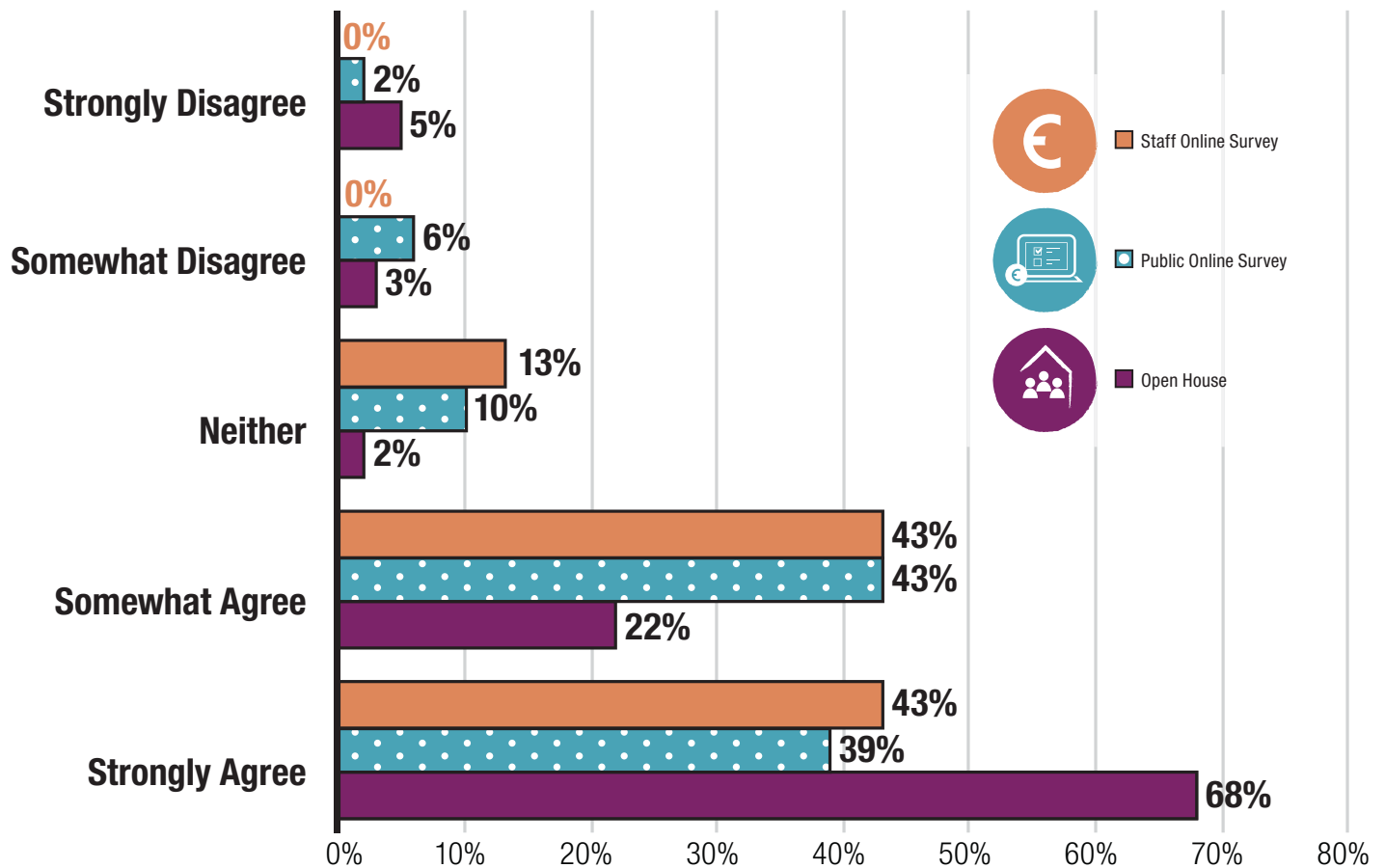

WHAT ARE THE TAKE-AWAYS?

- There is a high level of agreement that the draft facility schematic design meets community need.

SITE PLAN FEEDBACK

The following draft site schematic design was presented throughout the engagement activities. The design shows the different elements included on the site as well as their relationship to each other. We asked you about your satisfaction with the draft site schematic design and if you felt that the design meets the needs of the community.

DRAFT SITE SCHEMATIC DESIGN

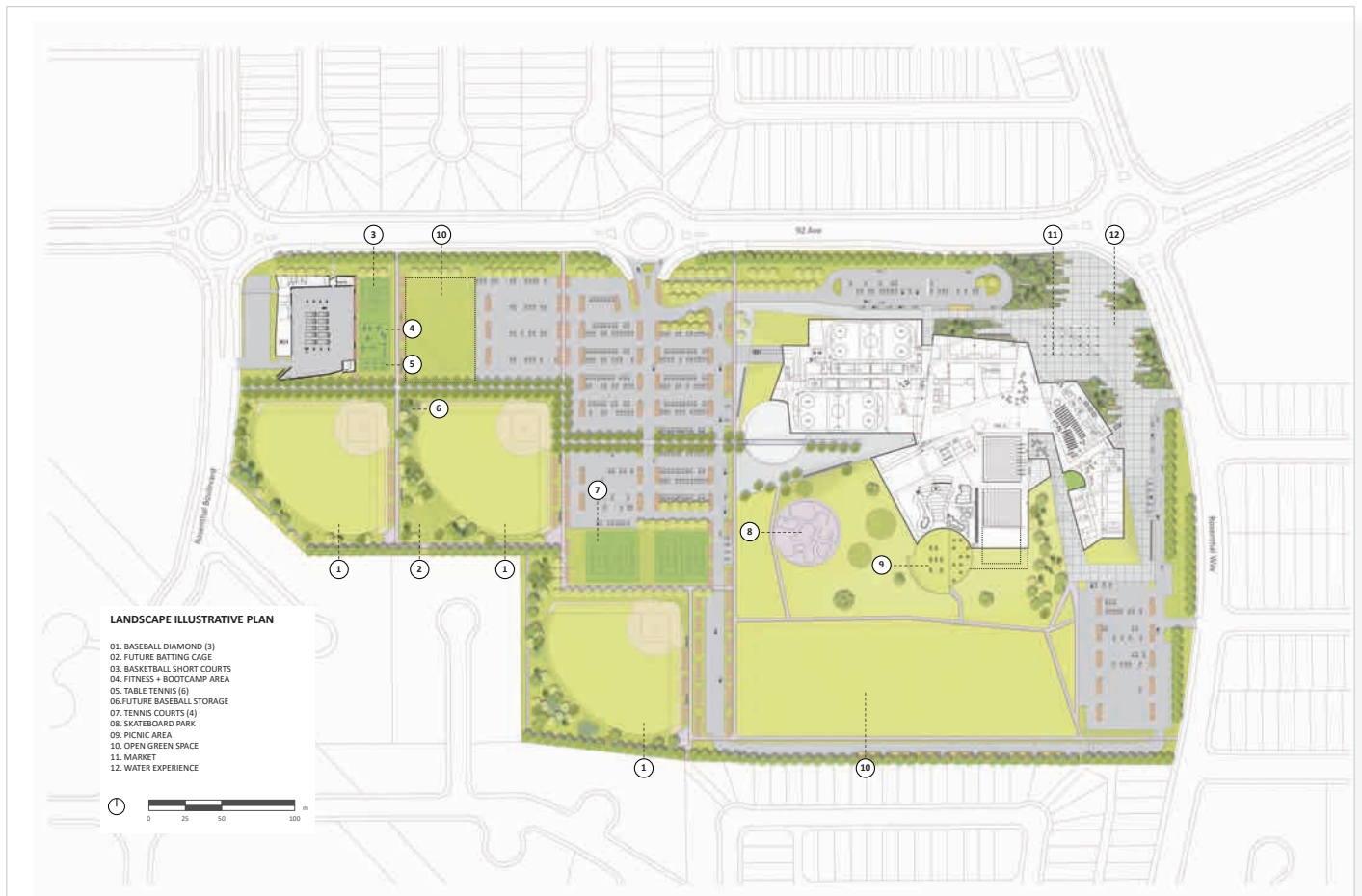

SATISFACTION FEEDBACK

We asked you to think about how you would use the site and tell us how satisfied you were with the draft schematic design.

LEVEL OF SATISFACTION WITH DRAFT SITE SCHEMATIC DESIGN

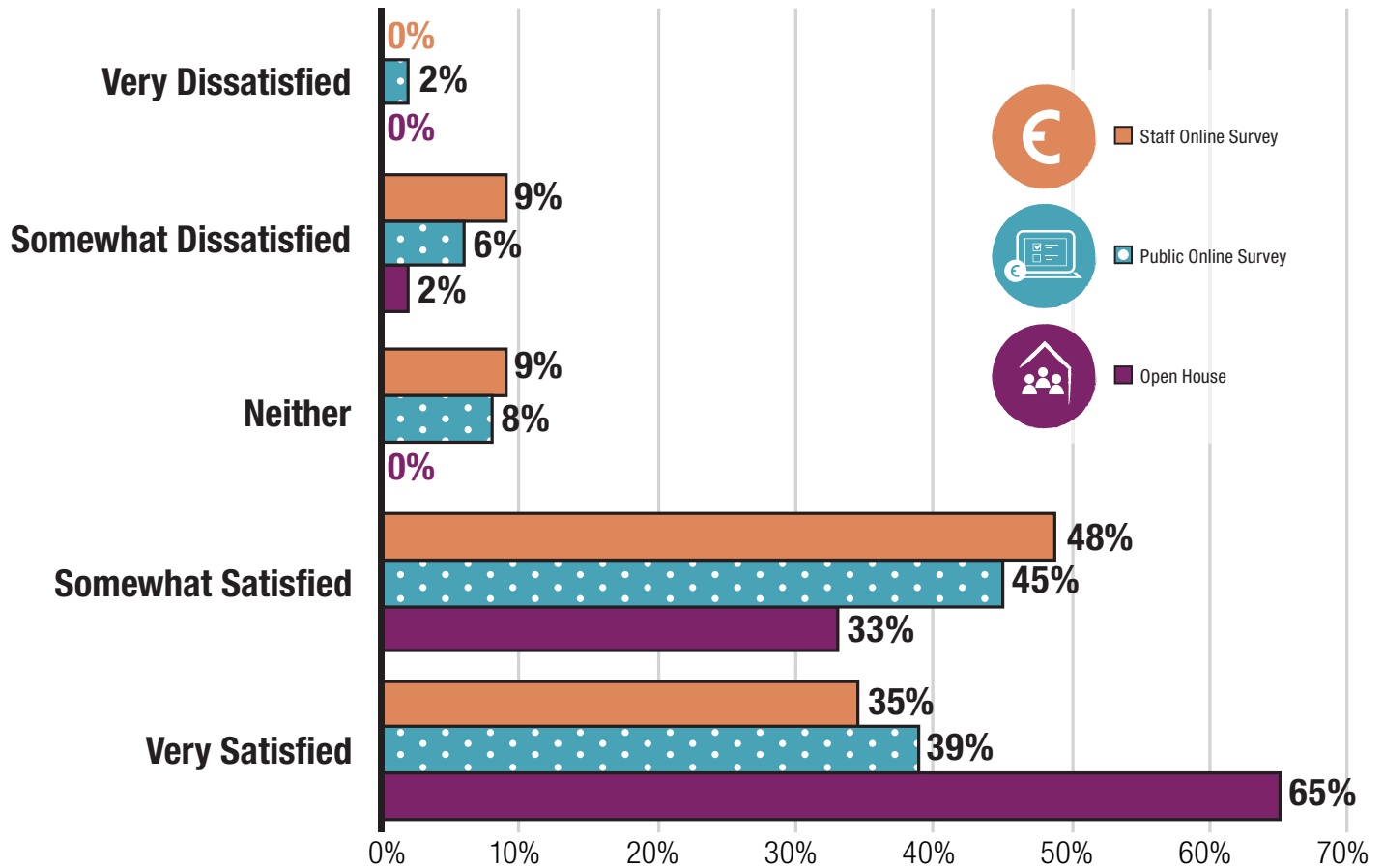

WHAT ARE THE TAKE-AWAYS?

- There is a high level of satisfaction with the draft site schematic design.
- It was felt that the 53m pool should be included.
- There are concerns about parking: sufficient amount, distance from the facility.
- The inclusion of a soccer field and outdoor playground were identified as desired elements.
- The site design has been identified as meeting community need.

SUMMARY OF FEEDBACK

You provided comments about the draft site schematic design. These comments were compiled with the primary thoughts presented as follows.



PUBLIC OPEN HOUSE

PUBLIC OPEN HOUSE

SATISFIED

- Good job with the design.
- The larger pool should be included as part of the design.

NEITHER SATISFIED OR DISSATISFIED

- There are too many ball diamonds in the design.

DISSATISFIED

- An outdoor playground is needed on site.
- Parking is too far from the facility.



PUBLIC ONLINE SURVEY

PUBLIC ONLINE SURVEY

SATISFIED

- The 53m pool is an essential component.
- The design is good and makes good use of the space.
- A soccer field should be added to the site.
- The design accommodates a lot of activities.
- The amount of parking is questionable. It is important to ensure parking demands are met.

NEITHER SATISFIED OR DISSATISFIED

- The 53m pool should be included in the facility.
- A spray park is needed as is a playground.

DISSATISFIED

- The 53m pool is needed in the facility.
- There are too many ball diamonds on the site.
- A soccer field is needed.
- The site shows too much green space.



CITY STAFF ONLINE SURVEY

CITY STAFF ONLINE SURVEY

SATISFIED

- Good variety of spaces.
- The inclusion of the water features is questionable.
- A lot of green space. It may need to be programmed or naturalized.
- Meets community need.

NEITHER SATISFIED OR DISSATISFIED

- Viewing areas should be considered for outdoor elements.
- Connections between inside and outside elements need to be emphasized.
- Natural elements in landscaping could provide placemaking impact.

DISSATISFIED

- Site layout is more linear than building
- Main entrance is away from most parking.
- Change area near water play area is needed.

COMMUNITY NEED

We asked you to what extent do you agree that the site design meets the needs of the community.

LEVEL OF AGREEMENT THAT THE DRAFT SITE SCHEMATIC DESIGN MEETS COMMUNITY NEED

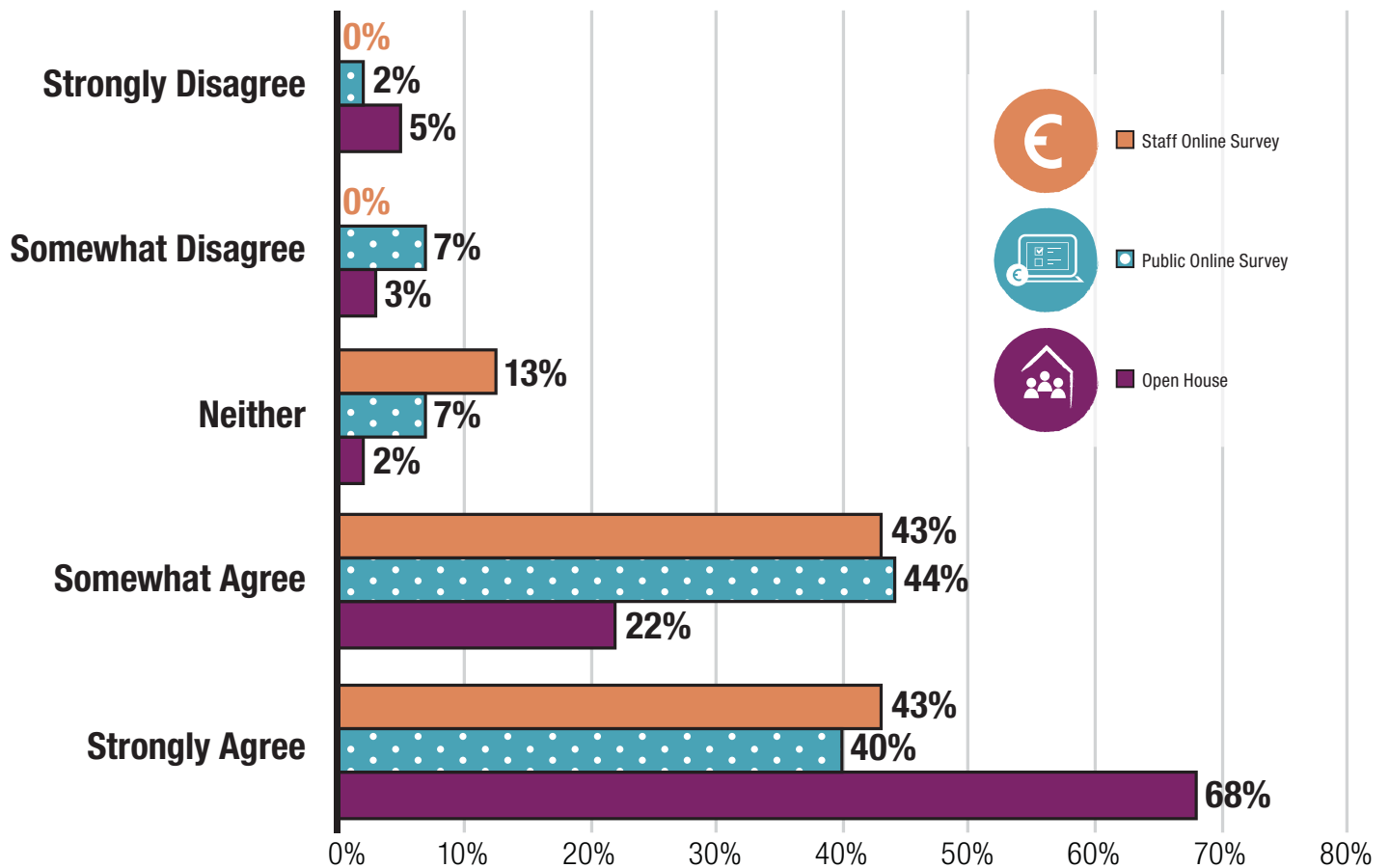

WHAT ARE THE TAKE-AWAYS?

- There is a high level of agreement that the draft site schematic design meets community need.

PREFERENCE 53M POOL VS. GREEN SPACE

We asked you to consider the trade-off between the large (53m) pool and green space. Specifically, we asked “Should the City spend \$8M on the larger pool or should we build more flexible green space on the park site?”

Participants were informed that the aquatic activities they deemed most important¹ would be accommodated in either a 53m pool or a 25m pool.

SHOULD THE CITY SPEND \$8M ON THE LARGER POOL OR SHOULD WE BUILD MORE FLEXIBLE GREEN SPACE ON THE PARK SITE?

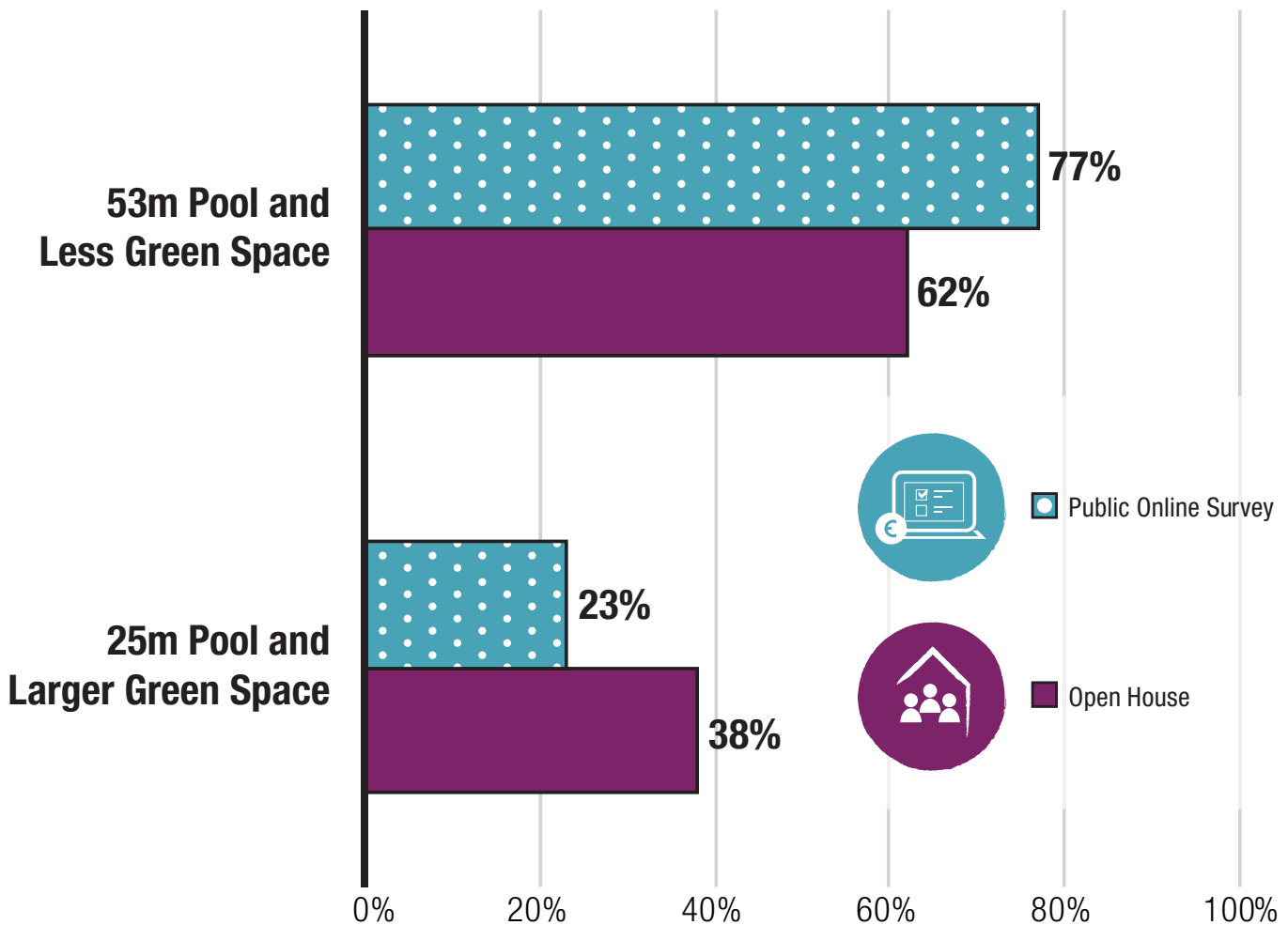

¹ Activities included: swim lessons, lane swim, fitness programs, water play, using a hot tub, open green space, markets, picnicking, event space, resting/relaxing.

OTHER COMMENTS & OPEN HOUSE FEEDBACK

You provided other comments about the facility and park. These comments were compiled with the primary thoughts presented as follows.



PUBLIC OPEN HOUSE

- The larger 53m pool should be included in the facility.
- An outdoor playground should be on the site.
- Indoor soccer amenities are needed in the facility.
- The site should have soccer field(s).
- The fitness area in the facility should be larger.
- There is concern about the traffic issues in the area due to the facility.



PUBLIC ONLINE SURVEY

- The 53m pool should be included in the Lewis Park facility.
 - The larger pool would enable event hosting.
 - The larger pool will support elite/competitive athletes.
 - The inclusion of the 53m pool will support the Kinsmen Aquatic Centre.
- This Lewis Farms facility is needed and should be built as soon as possible. It is particularly needed in the west end.
- The City has done a good job of planning for this facility.
- An outdoor spray park should be added.
- An outdoor playground should be added to the site.
- A complete traffic impact study is needed.



CITY STAFF ONLINE SURVEY

- Inclusion of the 53m pool is good.
- The facility will become a community hub.
- Connections between the inside and outside spaces are needed.
- Need to ensure public recreational use of the aquatic centre is not sacrificed for swim/diving meets.

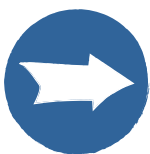

SETTING THE DIRECTION

OCT 04



PUBLIC OPEN HOUSE

THINGS PEOPLE LIKED AT THE OPEN HOUSE

- Our staff: Participants felt our staff was knowledgeable and well informed to answer their questions. Staff encouraged questions and discussion.
- The ability to view the detail plans.
- The amount of information presented.

THINGS WE COULD DO BETTER

- Convene the open house near where the facility will be located.
- Use a larger room to host the open house.

Overall, the majority of people that went to the open house and responded online felt that we did a good job providing people opportunities for input. The open house event itself was viewed positively. Here are some of our learnings from the event and suggestions for improvement for future consultation activities.

WHAT WE DECIDED

Based on your review of the draft schematic designs and internal discussions, we made some decisions about the facility and park design moving forward. Some of your feedback is not included because it is too early for the detail level of this phase, but it will not be forgotten as we move forward in the design of the project. This list provides a summary of the decisions we made and why.



AQUATIC CENTRE

At the December 5, 2016 Community & Public Services Committee meeting, Council also made the decision to add the 7.5m & 10m dive platforms to the Lewis Farms aquatic centre.



AQUATIC CENTRE

During Setting the Direction we heard support for the layout of the facility, however, there was more circulation space than necessary in the design so approximately 8,000 m² of space was removed to avoid overbuilding.



CIRCULATION SPACE

On December 5, 2016, the Community & Public Services Committee was presented the results of the Setting the Direction engagement where we asked you about your preference between a larger 53m pool or more open green space. Based on the engagement results and information presented, the Council committee made the decision to add the 53m pool to the Lewis Farms aquatic centre.

WHAT WE HEARD

Taking your feedback from the Setting the Direction consultation into account and incorporating Council's direction to include the 53m pool and 7.5m & 10m dive platforms, we have finalized the schematic design for the Lewis Farms Facility & Park. The designs are presented in this section of the report. These designs will be the guide for the detailed design phase.

GROUND LEVEL

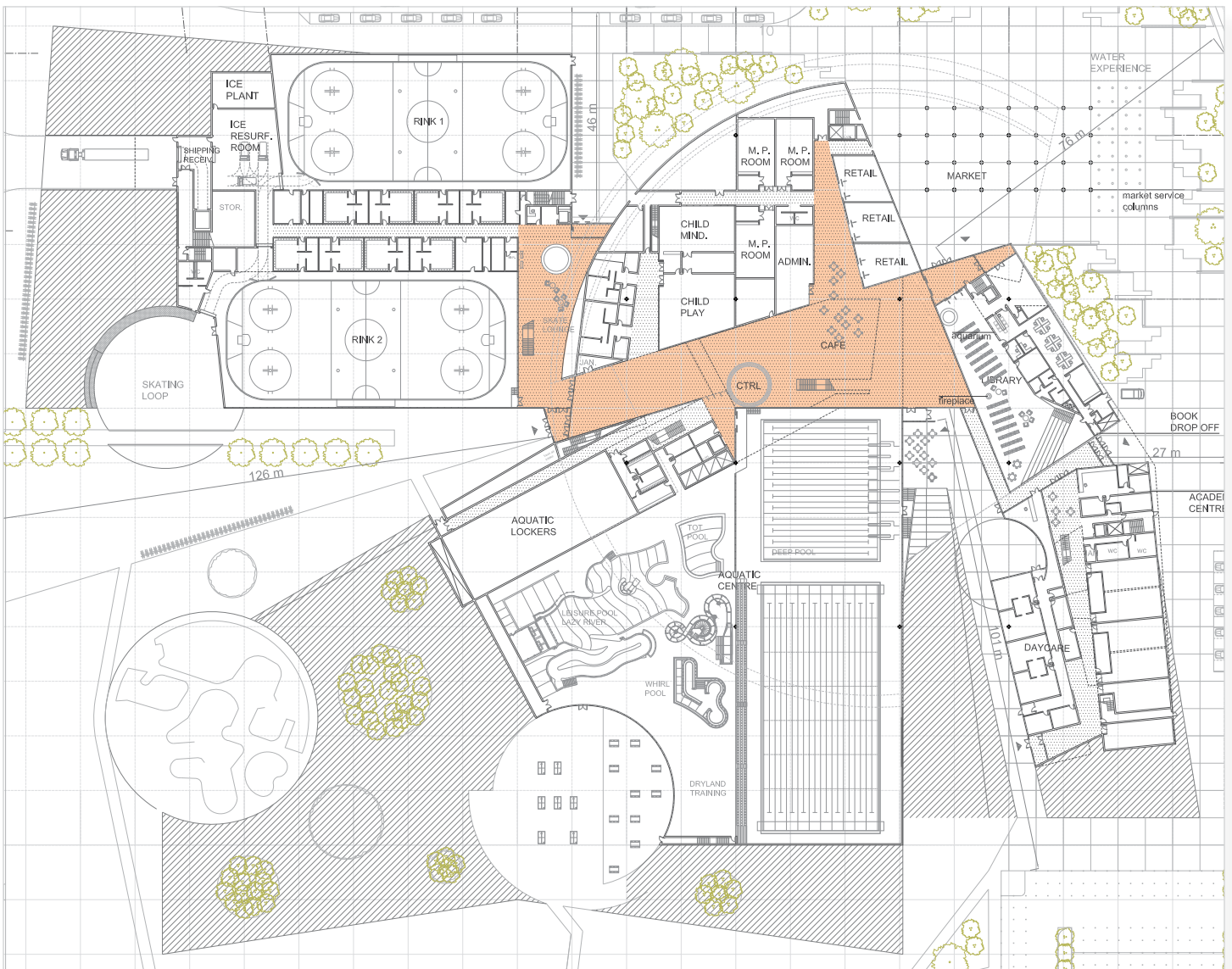

SECOND LEVEL

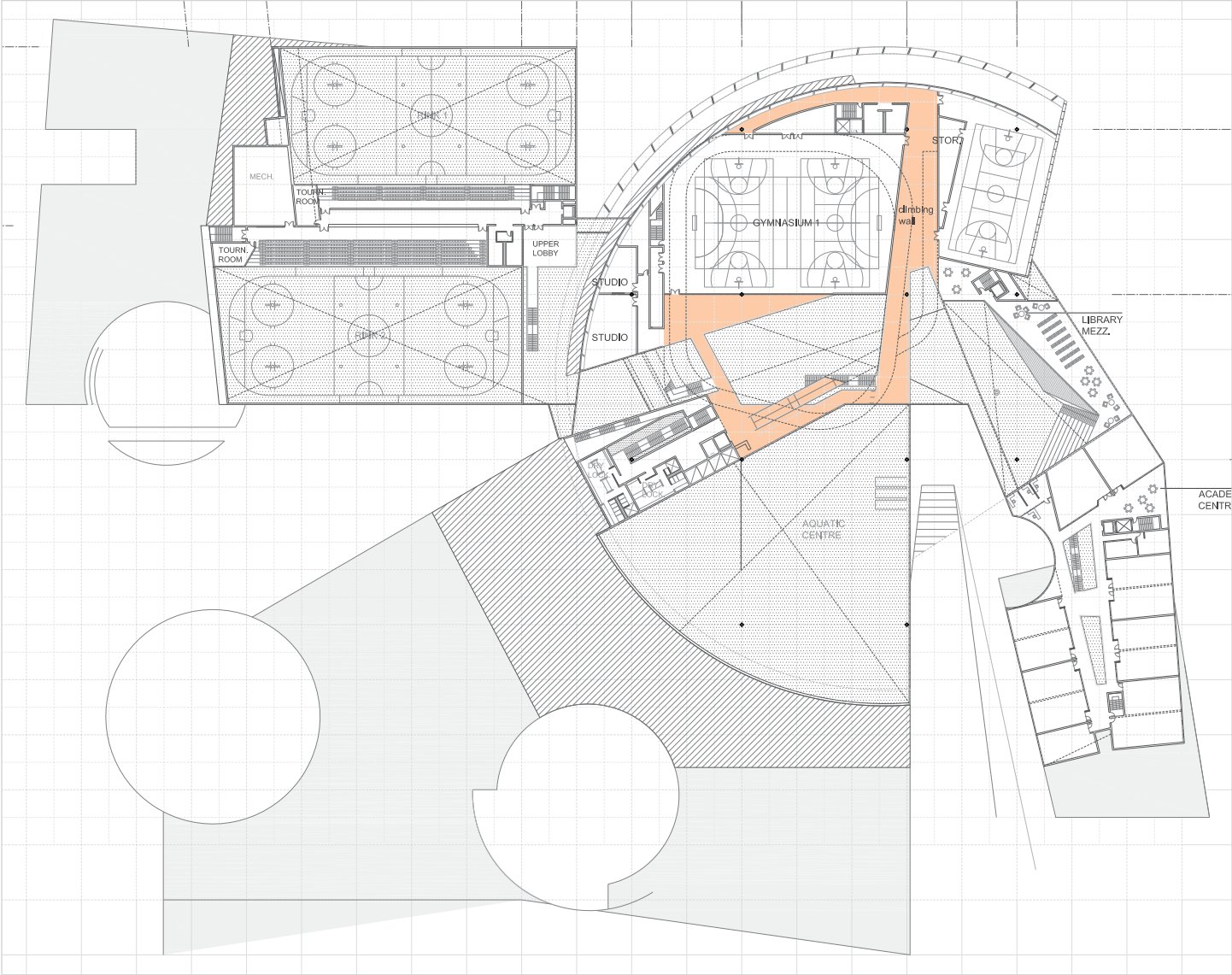

THIRD LEVEL

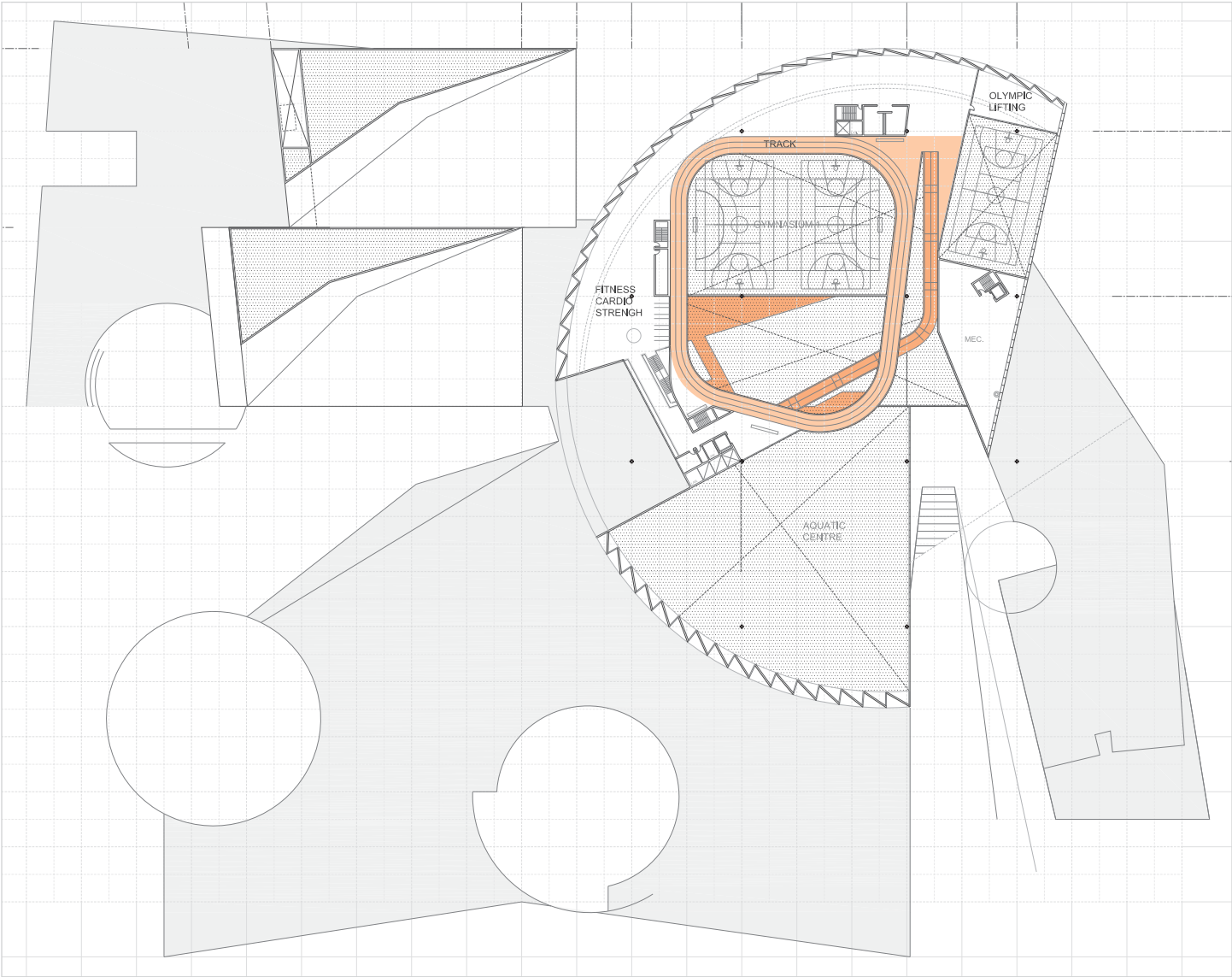

ROOF

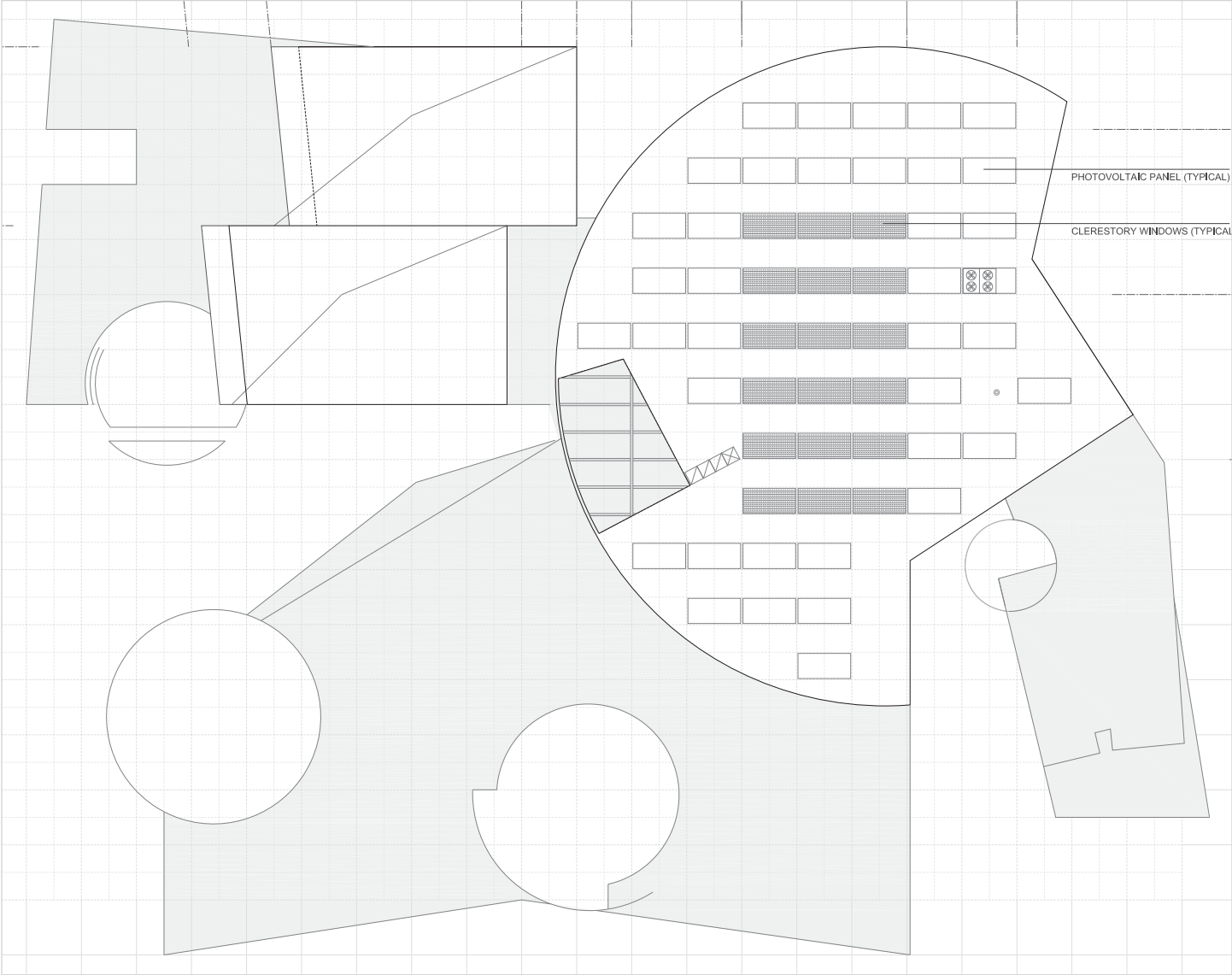

WHAT WE HEARD

SITE

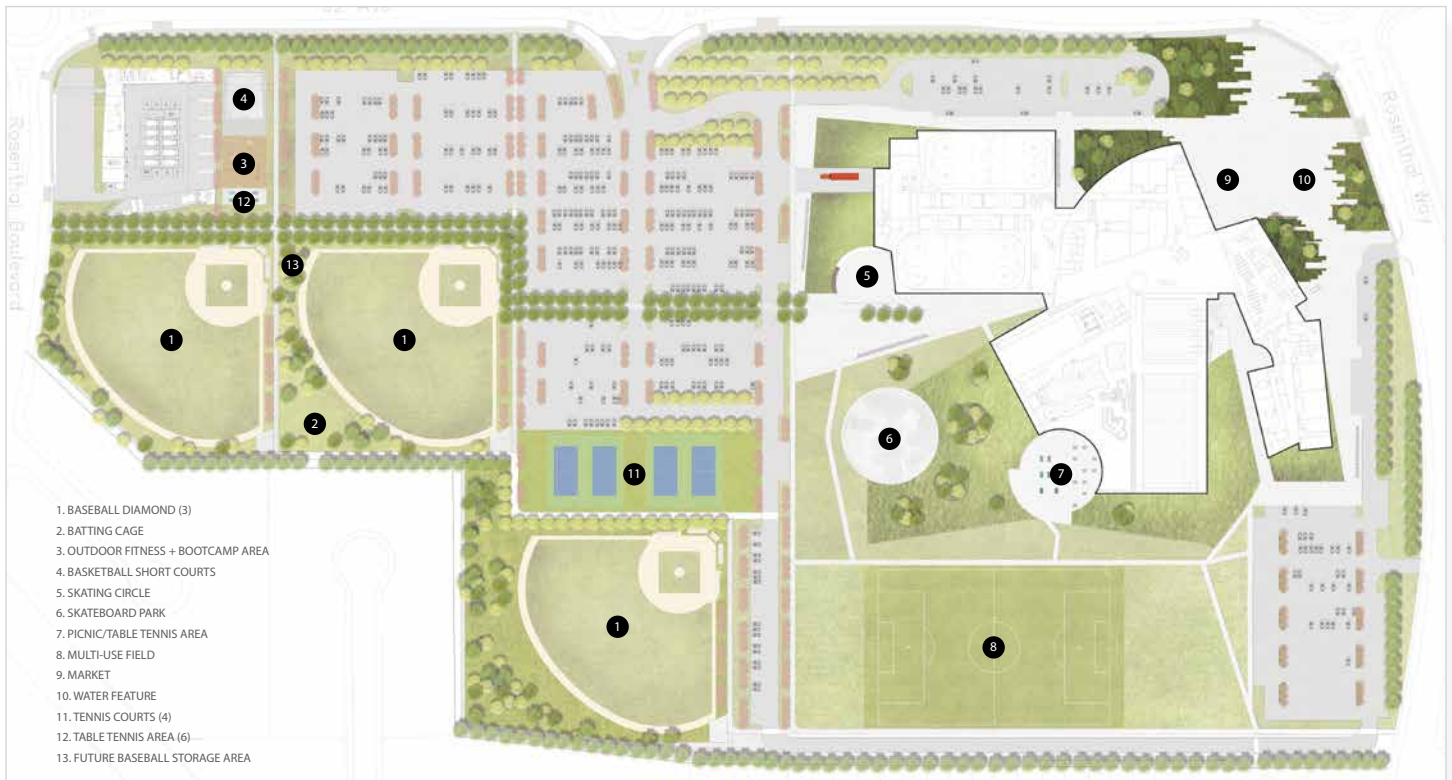

WHAT'S NEXT

Our next step is to provide all this information to the architect to finalize the schematic design.

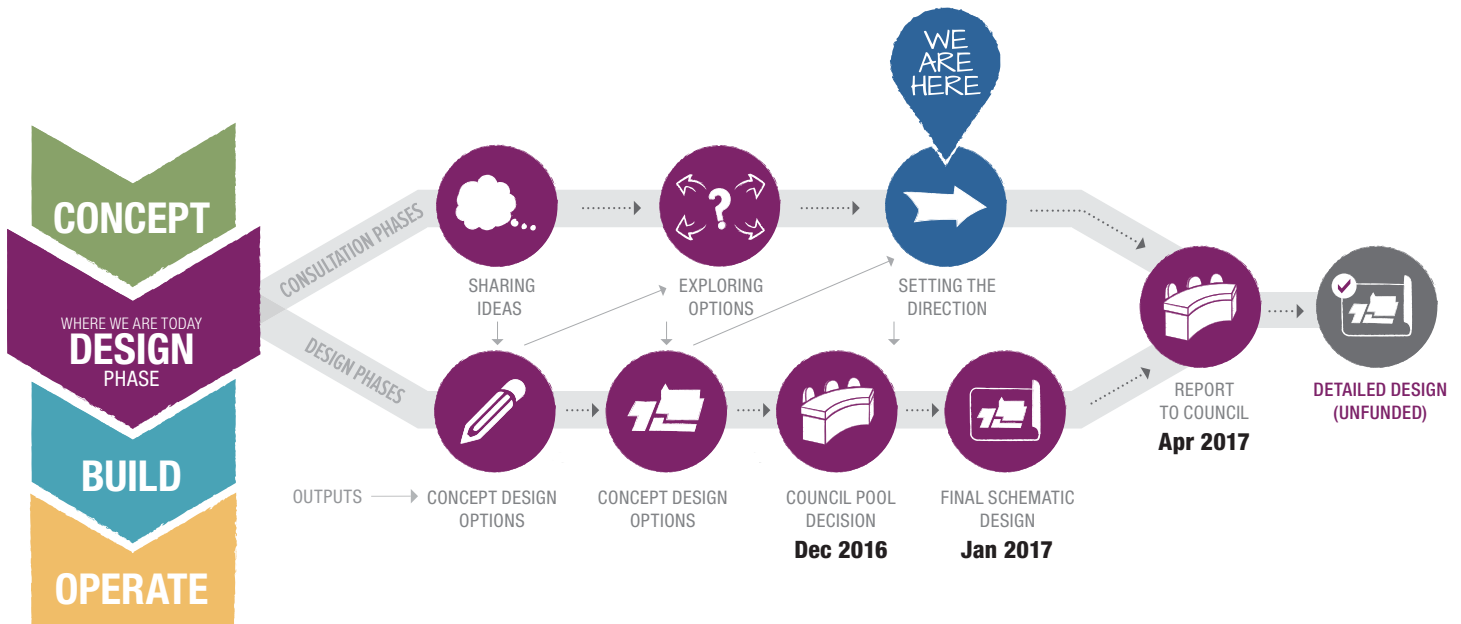

NEXT STEPS

- Based on public input, in April 2017 the schematic design and the details and cost of the Lewis Farms Facility and Park will be shared with City Council for future direction.
- The detailed design stage will begin if funding for the remaining design and construction is approved and the following triggers are reached:
 - Dedicated Land: the Lewis Farms District Park is currently unassembled. Sustainable Development is currently working on the land assembly and plans to report to Council in early 2017 with an update.
 - Base Infrastructure: projects such as roads and utilities next to the proposed centre should be completed to reduce cost impacts.
- Further public and stakeholder consultation will occur during the detailed design phase.

HERE'S HOW YOU CAN STAY INFORMED



CHECK OUT OUR WEBSITE

www.edmonton.ca/lewisfarmsfacilityandpark

