



What We Heard Report Lorelei and Beaumaris Neighbourhood Renewal

**Vision, Guiding Principles &
Community Knowledge**

February 2019

**SHARE YOUR VOICE
SHAPE OUR CITY**

Edmonton

Public Engagement Roadmap

The Neighbourhood Renewal program follows the roadmap below. Currently, we are **Building a Project Vision Together** and **Exploring Opportunities**.



Public Engagement Spectrum

Public Engagement at this stage in the project will:

- + **CREATE** a vision and guiding principles
- + **REFINE** infrastructure options
- + **ADVISE** on neighbourhood assets, opportunities, and priorities



Decision-Making Process

It is important to note that while public engagement is a critical aspect in the decision-making process, there are several inputs that will also be considered along with public input in determining what is ultimately built with neighbourhood renewal. Some of these factors include City policy and programs, technical requirements, and available funding.

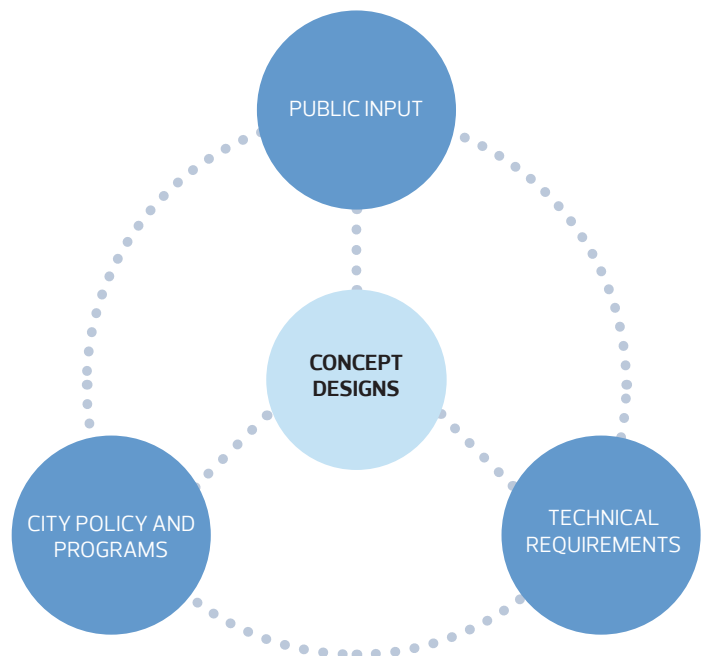

Public Engagement Activities

What We Did

We held a Community Walk and Workshop on November 28, 2018 at the Ecole Bishop Savaryn Catholic School from 5:00 to 9:00 pm.

- + The Community Walk included a guided walk around Lorelei and Beaumaris to develop a better understanding of the neighbourhood.
- + The Workshop focused on developing a vision and guiding principles and identifying opportunities for improvements.

An Online Survey was also available to the public from November 28, 2018 to January 9, 2019.

What We Asked

We asked residents to help create a vision and guiding principles for renewal in Lorelei and Beaumaris and identify strengths, weaknesses, opportunities and constraints. Please see page 8 for what we heard.



More than 35 people shared their ideas on the Vision, Guiding Principles and Local Knowledge.

Public Engagement Activities Timeline

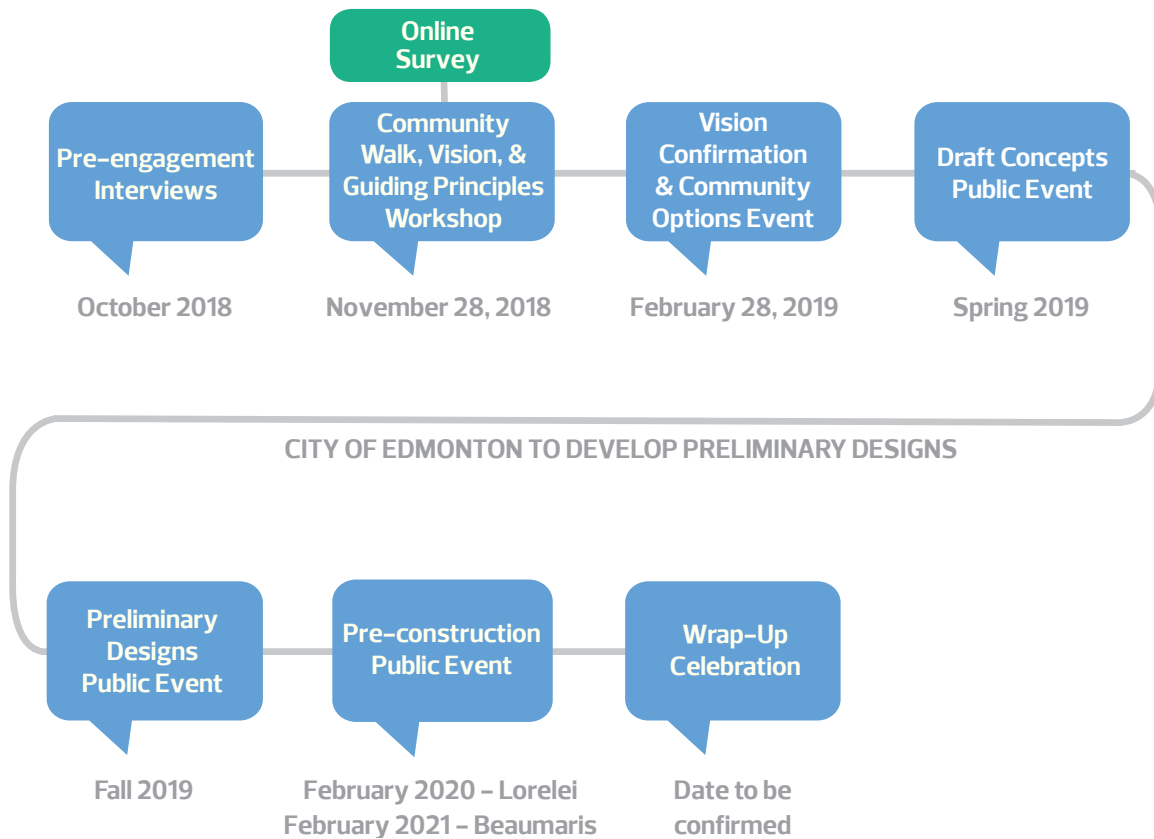

Community Walk, Vision, & Guiding Principles Workshop

What We Heard

The following sections includes a summary of what we heard at the Community Walk and Workshop and through the Online Survey. The summary has been developed to reflect the relevancy, frequency, and diversity of the responses we received based on the questions that were asked to residents.

What are your three favorite things about Lorelei/Beaumaris today?

(survey only)

- + Close to nature including Beaumaris Lake and several parks and pathways
- + Access to schools and shopping centres
- + Mature trees, landscaping, and connected pathways
- + Quiet neighbourhood that is relatively safe, with friendly people and neighbours
- + Bus service and excellent access to downtown
- + Established neighbourhood with a good mix of demographics

What are some of the challenges you face moving and living in and around your neighbourhood? (survey only)

- + Cracked and broken pavement and sidewalks
- + Steep curbs to access driveways
- + The lighting from street lights is not adequate for pedestrians
- + Poor walking trails and roads, and old parks and playgrounds
- + Increase of vehicle traffic on local collector roads in recent years
- + Walkways near the lake are not wide enough and need more lighting
- + Criminal activities in some of the dark areas of the neighbourhood
- + There are not enough sidewalks due to sidewalks only being on one side of the road in some areas or missing connections to destinations

Thinking about a renewed Lorelei/Beumaris, what would you like to see changed? Upgrades will be required to support the community for the next 30 to 40 years. (survey only)

- + New LED lights along walkways
- + Better upkeep and snow removal on walkways
- + More mixed use development and vibrancy
- + Improving crosswalks to make them safer for young children
- + Well-connected sidewalks
- + Improved bike lanes



What is your vision for the future of the neighbourhood? (workshop and survey)



People

- + A community that is supportive of aging in place, and young families
- + Family-friendliness
- + Staying active throughout the community



Nature

- + Maintain the beauty of the neighbourhood, and nature within the city
- + Parks define the neighbourhood
- + Keep the landscaping natural and preserve trees



Connectivity

- + A connected and walkable neighbourhood, that is easy for people to get around
- + Accessible for all modes of transportation
- + Easy to walk and drive to destinations within the community and surrounding area (Beaumaris Lake, commercial areas, etc.)
- + Easy access to shops, schools, parks, etc.



Safety

- + Safe and secure with less crime and speeding
- + Lighting which enhances safety
- + Safer intersections for pedestrians when crossing



Character

- + "Mature" or "Classic" Neighbourhood that is well-rounded
- + Reflective of the history of the community
- + Increased density, vibrancy, and mixed-use development



Things to do

- + Improving key destinations in the community (schools, parks, commercial areas)
- + Gathering places in the community which are safe
- + Beaumaris Lake as a gem in the community
- + Pet-friendly



Amenities/Design

- + More amenities to improve walkability (lighting, plants, waste receptacles, etc.)
- + All season design

Draft Vision Statement

Lorelei and Beaumaris are family-friendly neighbourhoods that welcome people of all ages and backgrounds. We are a safe and walkable community that is connected to key destinations like parks, schools and commercial areas. We are an active and vibrant community that enjoys nature and getting together with our neighbours.

Here are some guiding principles that the City sometimes hears about. Please select 5 out of 8 of the following principles that are most important to you. (survey only)

The guiding principles that are most important to residents support a neighbourhood that is **easy to walk in**, where people **feel safe**, and where the **natural environment** is preserved and enhanced.

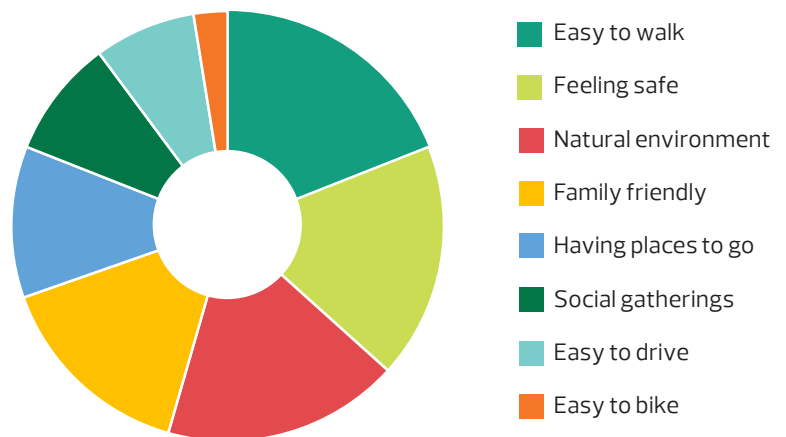

What are some guiding principles for the neighbourhood? (workshop and survey)

Draft Guiding Principles

- + Creating year-round opportunities to be active throughout the community
- + Celebrating nature and preserving trees and open spaces
- + Feeling safe and having well-lit spaces
- + Reflecting on the history and character of the neighbourhood
- + Having viable options to walk, bike and drive
- + Improving the connectivity to other neighbourhoods and nearby amenities
- + Making the roads safer for all users (people who walk, bike, drive)
- + Creating places for the community to come together and gather
- + Creating easy access to neighbourhood destinations such as commercial areas, schools, parks and Beaumaris Lake

Strengths, Weaknesses, Opportunities & Constraints Analysis

We developed a strengths, weaknesses, opportunities, and constraints analysis based feedback from the public engagement activities. A summary of what we heard has been included on the following pages. We will consider this feedback when identifying areas for improvements through neighbourhood renewal.

Lorelei

Strengths

- + Strengths include the linear park and pathway along the power line corridor, the mature trees and park spaces, and the proximity to Beaumaris Lake and nearby commercial amenities.
-

Weaknesses

- + Weaknesses include speeding along Beaumaris Road, pedestrian safety, lack of lighting, steep curbs, and crime and vandalism in certain areas
-

Opportunities

- + Opportunities include improved pedestrian crossings and traffic calming measures along Beaumaris Road. Other opportunities include the addition of amenities and improvements to existing green spaces, parks and pathways, including finishing the connection along the power line corridor.
-

Constraints

- + Constraints include the surrounding arterial roads which can negatively impact the regional connectivity of the pathways within the neighbourhood.
-

Beaumaris

Strengths + Strengths included the proximity to Beaumaris Lake and nearby commercial centres and amenities, as well as the park spaces and street trees within the neighbourhood.

Weaknesses + Weaknesses include speeding along Beaumaris Road, concerns about pedestrian crossings, drainage issues, and a lack of lighting in certain areas near park spaces.

Opportunities + Opportunities include traffic calming measures along Beaumaris Road, and the addition of amenities and improvements to parks, pathways and green spaces.

Constraints + Constraints include the lack of regional bike connectivity due to the surrounding arterial roads, issues with people backing up out of their driveways on Beaumaris Road, and traffic congestion.

Additional Feedback Received

The following feedback was received that relates to other City projects and maintenance. This information will be shared with the appropriate groups for consideration and follow-up.

- + It does not feel safe to walk around Beaumaris Lake*
- + There is dangerous ice build-up and litter near Beaumaris Lake*
- + Alleys are dark and feel unsafe
- + There is a lack of regional connectivity, due to the surrounding arterial roads

*For more information on the Beaumaris Lake Open Space Rehabilitation project, please visit: edmonton.ca/BeaumarisLakeRehabilitation

Strength, Weakness, Opportunity, Constraints Summary – Beaumaris

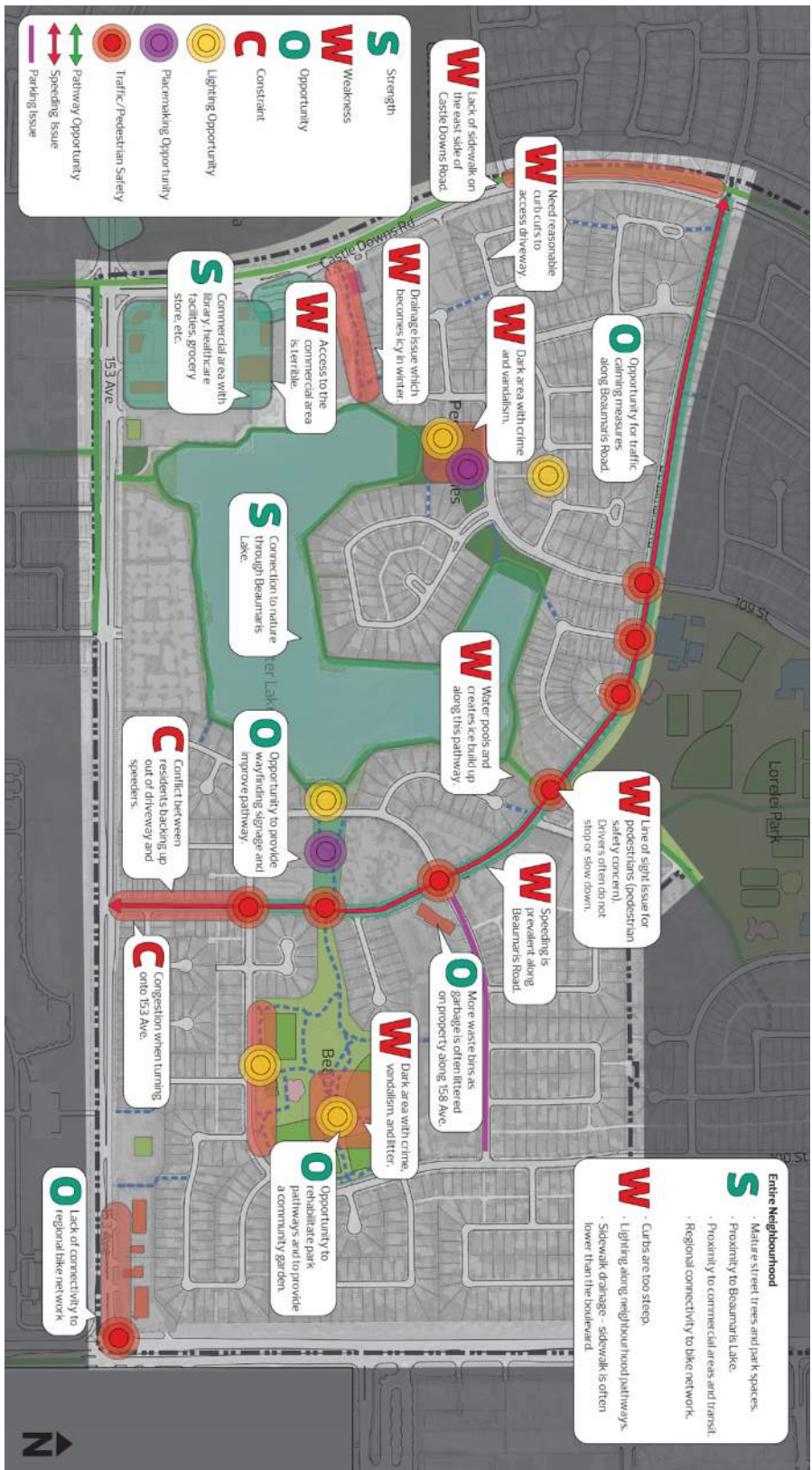

Next Steps

The next steps will include finalizing the vision and guiding principles, and refining the opportunity areas to develop draft concepts. These draft concepts will be brought back in Spring 2019 to gather feedback and get your help to refine them. Information will also be provided at future engagement events on the local improvement process for decorative street lights and sidewalk reconstruction.

Please visit edmonton.ca/BuildingLoreleiBeaumaris for more information, and to add your name to our email list so we can keep you informed of project updates.



Community Walk, Vision, & Guiding Principles Workshop



Working together to make the most out of your neighbourhood.

This is your city and your neighbourhood. We want to understand how you experience your neighbourhood and ask for your input on what we might do to make it better.

We will engage and work with you on the renewal of roads, sidewalks, street lights, and park spaces, and promote other community opportunities to enhance how people live and interact in your neighbourhood. We commit to being open and transparent about how your input is used. Let's make the most out of your neighbourhood.

For more information:

edmonton.ca/BuildingLoreleiBeaumaris
or call 311

SHARE YOUR VOICE
SHAPE OUR CITY

Edmonton