

Dear Neighbour

We are writing to share an update about a City-owned property at **9418 83 Street**.

As you may know, the City has been leading the construction of new supportive housing in Holyrood. On-site work is anticipated to be completed in the first quarter of 2025. When construction is complete, the building's ownership will be transferred to Homeward Trust.

Homeward Trust sought proposals from non-profit community service agencies to operate and provide onsite programming. After a thorough Request for Proposal (RFP) review process, George Spady Society, an experienced non-profit organization, has been selected as the operator.

What is Supportive Housing?

Supportive housing is a type of affordable housing that combines below-market rents with on-site health and social support services. Supportive housing is not a shelter, drop-in, bridge housing, halfway house or any other type of temporary accommodation. Residents are selected to ensure the services offered on-site meet their needs. They sign a lease, pay rent and create a permanent home for themselves. Supportive housing is critical infrastructure that will help prevent and end homelessness in Edmonton. To learn more about supportive housing, visit edmonton.ca/WelcomeHomes.

Who is George Spady Society?

GSS is a trusted and experienced supportive housing provider that currently operates three successful supportive housing sites in Edmonton, including Unity Manor (Westmount), Balwin Place and Canora Place.

Established in 1983, GSS is committed to fostering recovery and promoting stability through innovative and compassionate care. This is demonstrated by their diverse array of programs including medical detoxification services, palliative care, housing first programs, and mobile medical and clinical supports. Their approach is grounded in evidence-based practices, trauma-informed care, and a steadfast dedication to the dignity and well-being of each individual they serve. This approach also demonstrates the alignment of GSS services with City of Edmonton's Homelessness and Housing Services Plan and the Homeward Trust Edmonton Supportive Housing Program Standards.

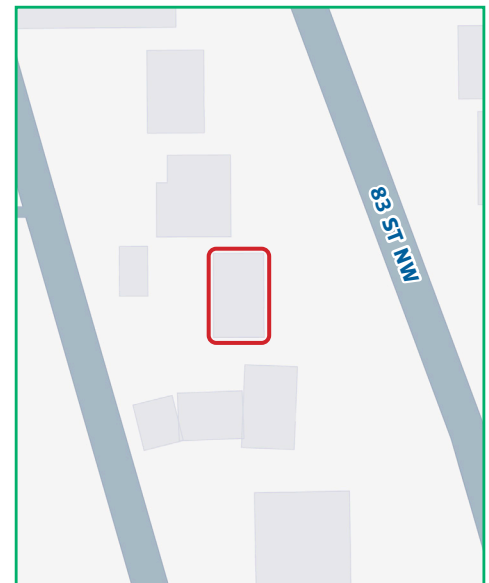

Who will be living at Holyrood?

Holyrood supportive housing will provide homes for Edmontonians who have experienced periods of chronic housing instability and are facing challenges related to mental health and substance abuse. This site will provide recovery-focused services as part of a coordinated network of personalized, community-based care designed to help people navigate substance abuse and mental health challenges. GSS will work with Homeward Trust to match and refer individuals who will benefit from the supports and services available at Holyrood, providing them with homes, a recovery pathway and stability to build their lives and support the community.

What services will residents of the supportive housing receive?

The Holyrood program will help participants discover and build their lives in an environment that supports personal development, self-determination and overall well-being. Residents will not only live at the Holyrood site, but will thrive and grow.

All residents have individualized care plans in consultation with Case Managers. In addition, Recovery Alberta will provide support to residents at Holyrood, offering each individual connection with personalized care to meet their unique needs. This support includes in-reach, consultation, assessment and connection to substance abuse and mental health supports as indicated. The team can also advocate for and support connection to various medical care supports through collaboration with other healthcare teams.



What should neighbors expect from staff and leadership at George Spady Society?

GSS is committed to being a part of the Holyrood community. They have rich experience in preparing, implementing and supporting Good Neighbor Commitments to ensure their supportive housing program supports a healthy and safe community.

GSS will ensure that the supportive housing building is well maintained, both inside and outside, implement a guest management policy and procedure, and work with their residents to be respectful.

GSS Managers understand the importance of engaging with the community and will proactively connect with neighbourhood businesses and residents in a variety of ways that support connection. Once GSS is up and running at Holyrood supportive housing, they will also have events (such as a BBQ and building tour) that will help acclimate the neighborhood to staff and residents. Please stay tuned for further information from GSS.

They will also be responsive to and follow up on concerns. Community partners and members have the right to have their complaints heard by GSS management.

Questions or Concerns? If you would like to provide feedback or file a formal complaint, please contact the Holyrood Program Manager, Joanita Udinyiwe by email at joanita@gspady.ab.ca

You can find more information about the site at gspady.org/sh-holyrood

You can find more information about the project, how the City helps create affordable and supportive housing at edmonton.ca/HousingDevelopments.



Questions?
Email SupportiveHousing@edmonton.ca