

Construction Notice – Shared-use path closure near Century Park Station

Beginning on/around **February 10**, Leducor, the Design-Build contractor for the project, will close the shared-use path west of 111 Street, between 23 Avenue and Century Park Station. This closure is necessary in order to remove the retaining wall and part of the berm next to 111 Street for the eventual expansion of the road to accommodate the LRT tracks.

Preparation work will involve removing existing infrastructure such as railings, fences and lighting. Once the retaining wall has been removed, the berm will be levelled before construction of the expanded roadway begins this summer. Part of the area will also be used to store equipment and supplies. Details about this work will be shared in a separate notice.

The shared-use path is expected to be closed until **summer 2026** to ensure this work can be completed safely. A detour will be in place throughout the closure.

Detour information:

Pedestrians, cyclists and wheelchair users will be rerouted onto the sidewalk east of 111 Street between 23 Avenue and 29A Avenue. Cyclists will be required to dismount before the Century Park Transit Centre to ensure the safety of people waiting for the bus on 111 Street. Western access to Century Park Station will be maintained for transit riders. Those not using transit are asked to cross 111 Street at 29A Avenue/Saddleback Road to prevent further congestion of the pedway at Century Park Station. Please refer to the map below for details.



SADDLEBACK ROAD

29A AVENUE

LEGEND

-  BARRICADED POINTS (CONSTRUCTION ACCESS ONLY)
-  CLOSED WALKWAY
-  OPEN WALKWAY
-  CENTURY PARK STATION ACCESS ONLY

111 STREET



Century Park Station

23 AVENUE

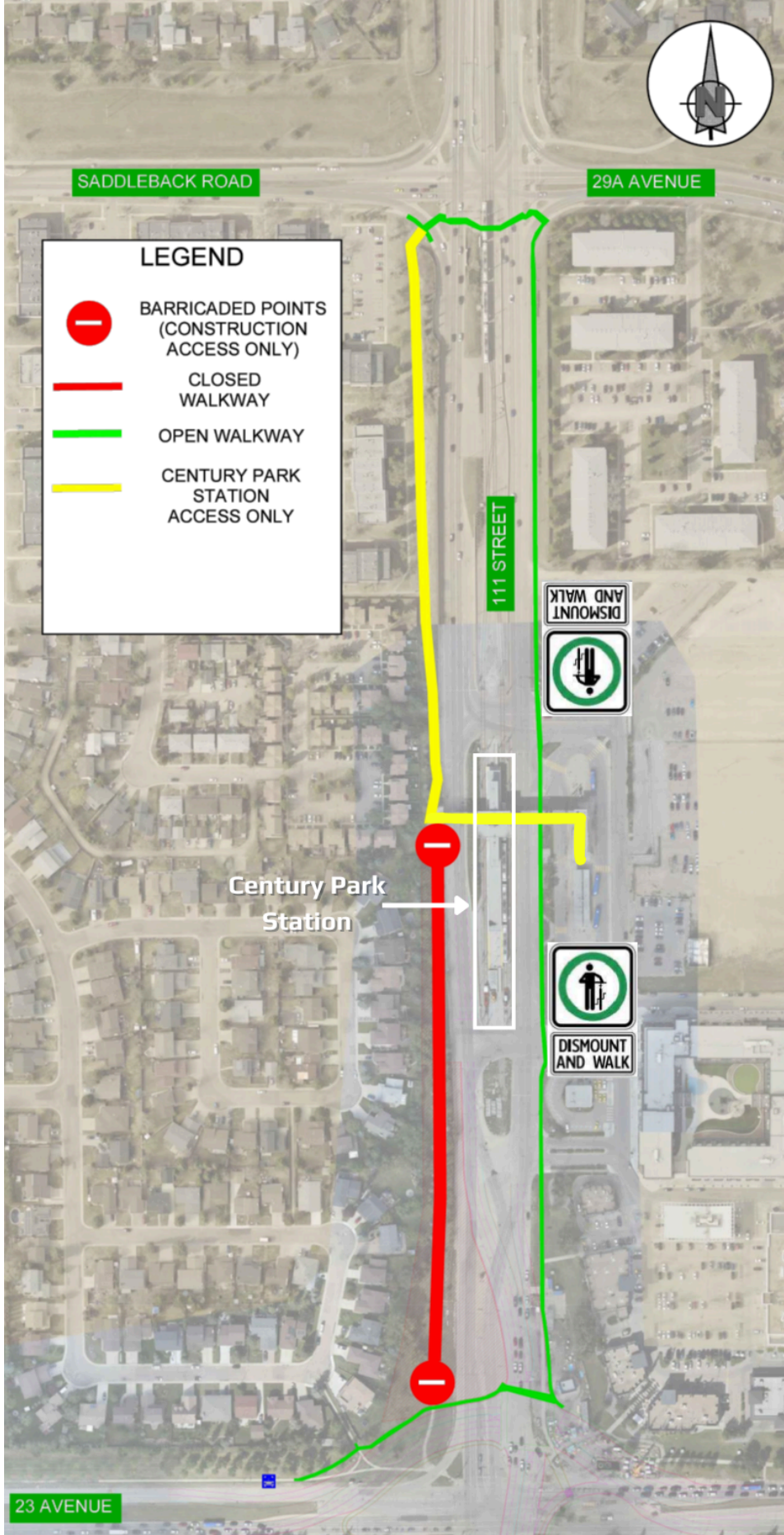

Other Impacts

- Work will occur on weekdays and Saturdays between 7:00 a.m. and 5:00 p.m.
- No traffic disruptions are expected during the work.
- Efforts will be made to minimize noise, vibration and dust. Mitigation measures will be implemented to monitor and reduce these impacts.

For More Information

City of Edmonton (general project inquiries)

Visit: edmonton.ca/capitalsw

Email: lrtprojects@edmonton.ca

Call: LRT Projects Information Centre at 780-496-4874 (voicemail)

Ledcor Group of Companies (construction-specific inquiries)

Email: capitallinesouth@ledcor.com

Call: Capital Line South public inquiry line at 780-540-7013 (voicemail)