

Project Origins

The Harbin Gate serves as a symbol of the strong cultural and historical ties between the city and the Chinese community. The original gate was officially opened in 1987 to commemorate the twinning of Edmonton with the City of Harbin in China’s Heilongjiang Province. The gate’s creation was advocated for by the Chinese Benevolent Association (CBA) which coordinated community funding to support that committed by the City and Province. For 30 years, it stood as a representation of the friendship and cultural exchange between the two cities.

The gate was taken down to make way for the Valley Line LRT in 2017. The design of a new replacement gate began in 2019.



OLD HARBIN GATE AT 102 AVE NW

Location

The City made a commitment to the public to construct a new Harbin Gate in the downtown core on 97 Street and 101A Avenue, where the original Edmonton Chinatown began. The new gate is to create a sense of connectedness in cultural experience, improve vibrancy of the surrounding area, and will be a memorable addition to the city’s identity, bookending the city’s old and new Chinatowns with the Gate of Happy Arrival at 107A Ave.

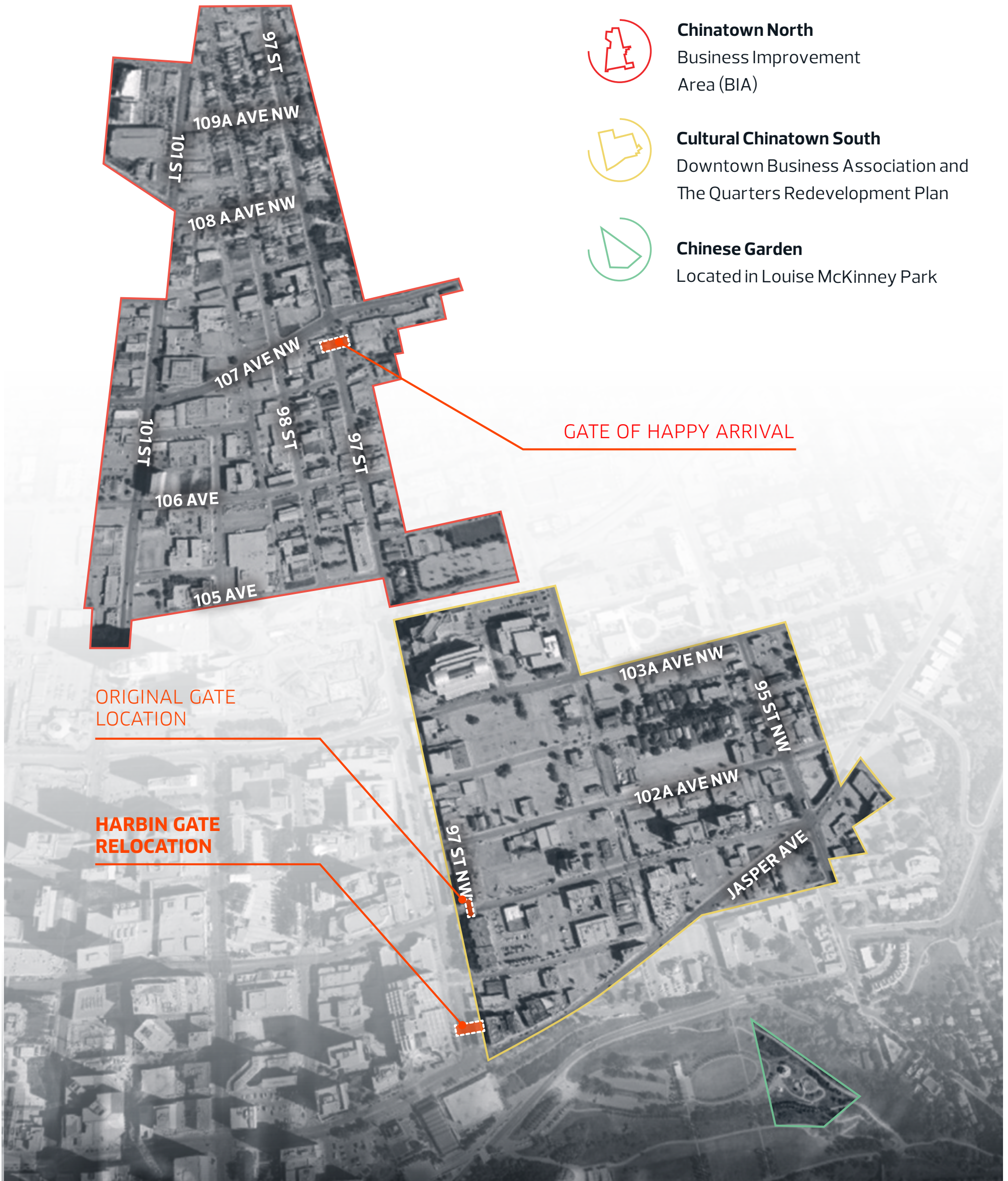

SOURCE: COE CHINATOWN STRATEGY

PROCESS

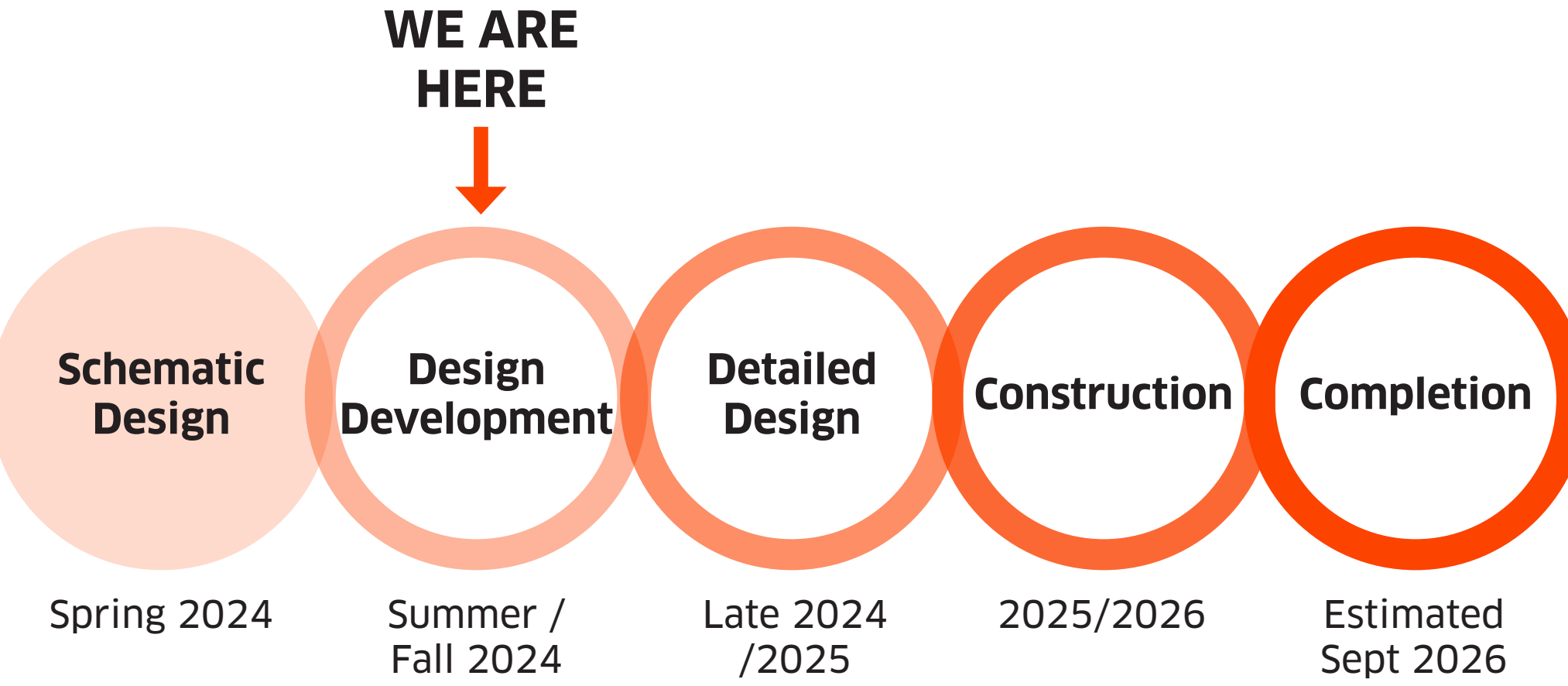

TIMELINE

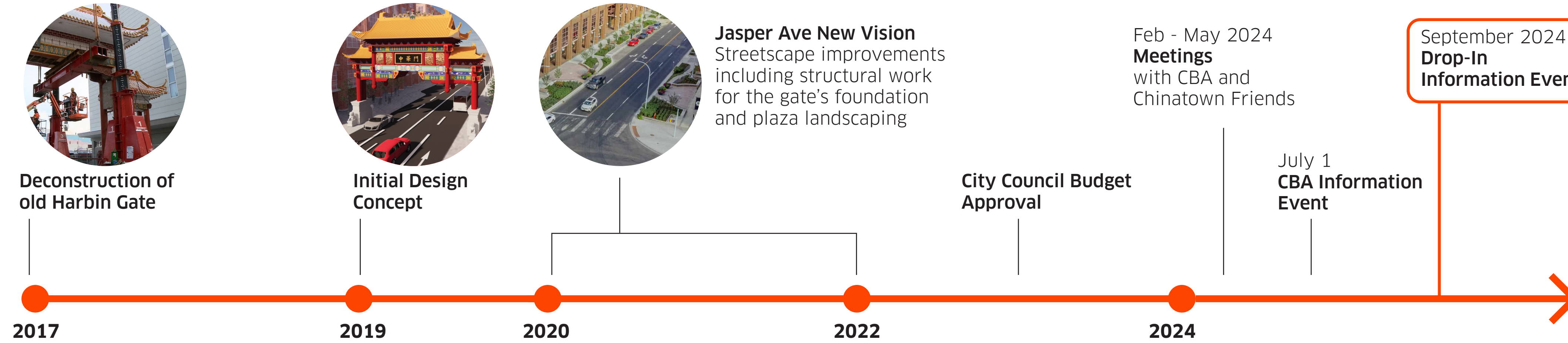

NEXT STEPS

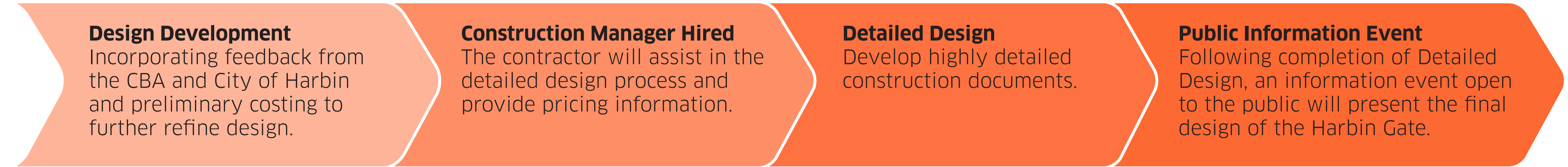





VIEW FROM JASPER AVE LOOKING NORTH

Design Gifted by City of Harbin

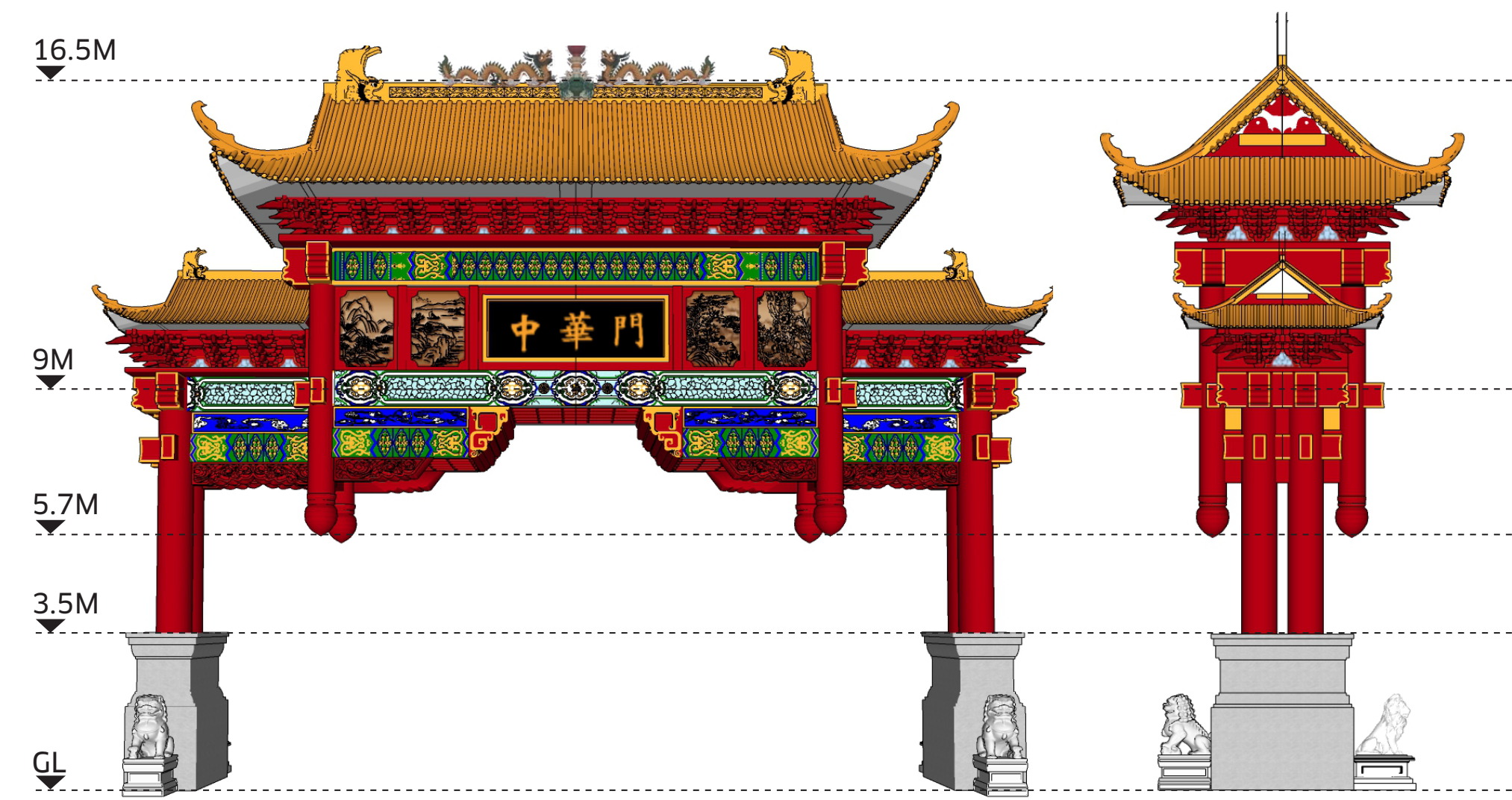

Following the deconstruction of the original Harbin Gate in 2017, a new design was provided by the City of Harbin in collaboration with a Beijing based architecture firm as a gift to the City of Edmonton.

Revised Design

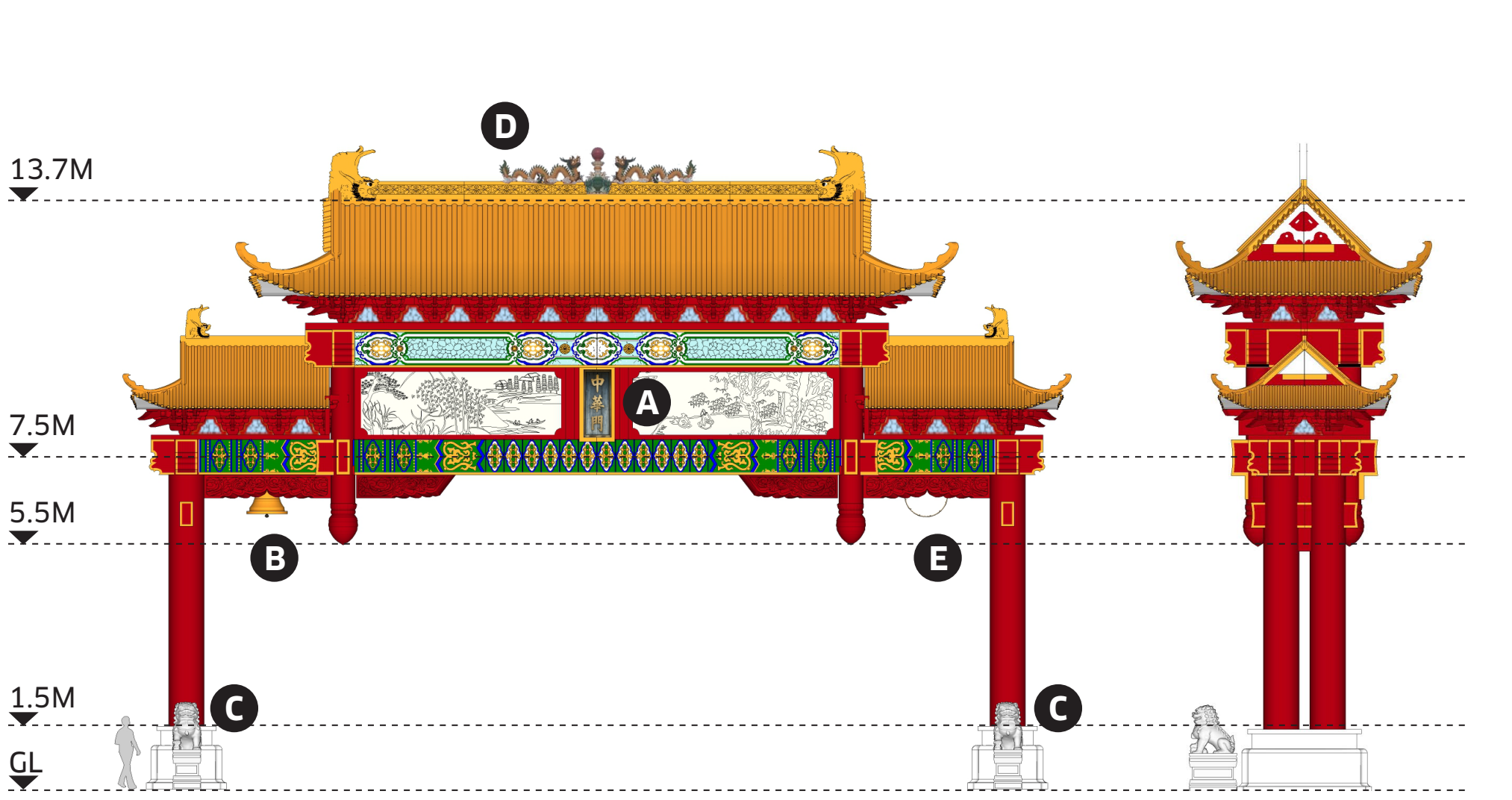

The revised design maintains the intent of the design provided by the City of Harbin while incorporating elements from the original gate, factoring in budget, constructibility and providing a more human-scaled experience in response to the surrounding context. The revised design pictured here is still in development and subject to further change based on design review and cost restrictions.

Reused + Replicated Elements

Elements from the original gate such as the plaque, bell and stone lions will be refurbished and incorporated into the new design to reflect the history of the Chinese community and to recognize the original gate’s importance to the residents of Edmonton in this neighbourhood and beyond. The plaque identifies the gateway as a place of confluence for Chinese culture in the city while the lions mark the entrance to the neighbourhood.

Elements from the original gate not available for reuse, including the dragon finial and drum, will be replicated and incorporated into the new design to pay homage to the old Harbin Gate.



A - “GATEWAY TO CHINATOWN” PLAQUE (REQUIRES REFINISHING)



B - CEREMONIAL BELL (REQUIRES REFINISHING)

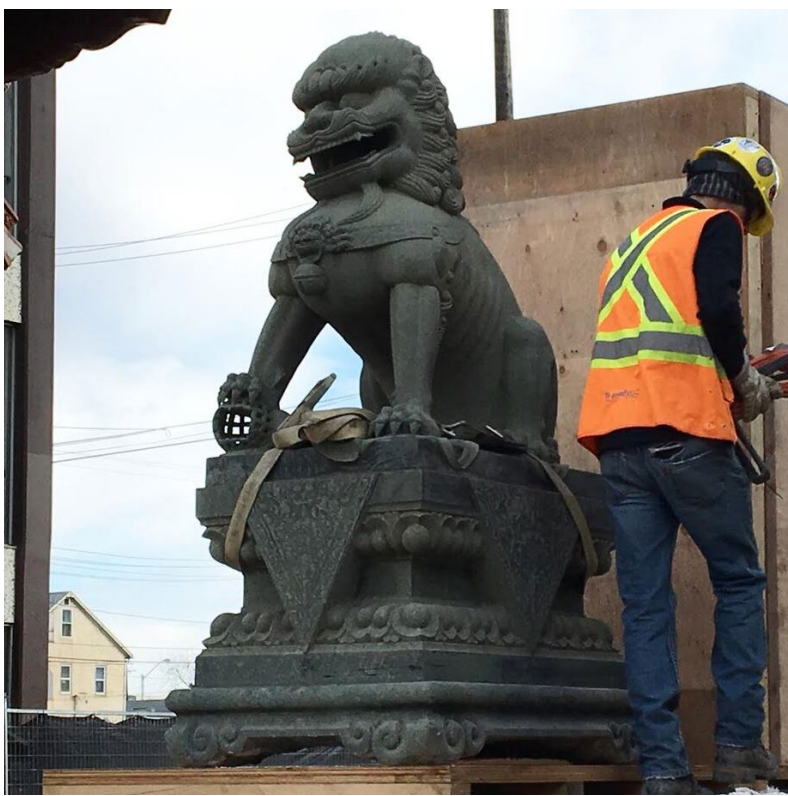

C - STONE GUARDIAN LIONS (TO BE CLEANED PRIOR TO INSTALLATION)



D - ROOF FINIAL (REPLICA)



E - DRUM (REPLICA)





VIEW FROM LOOKING TOWARDS JASPER AVE FROM 97TH ST

\* HATCHED REGIONS INDICATE OPPORTUNITIES FOR COLLABORATIVE ARTWORK OR ORNAMENTATION

The two-sided nature of the gate presents an opportunity for interpretations of Chinatown and Edmonton’s evolving history to be showcased on the North face. The South face will be designed by the City of Harbin. Other locations on the gate, including the columns and plinths, and surrounding urban realm can also allow for additional information, art, and interactions to be presented.

Gateway Plazas — Completed Landscaping — Pedestrian Experience —

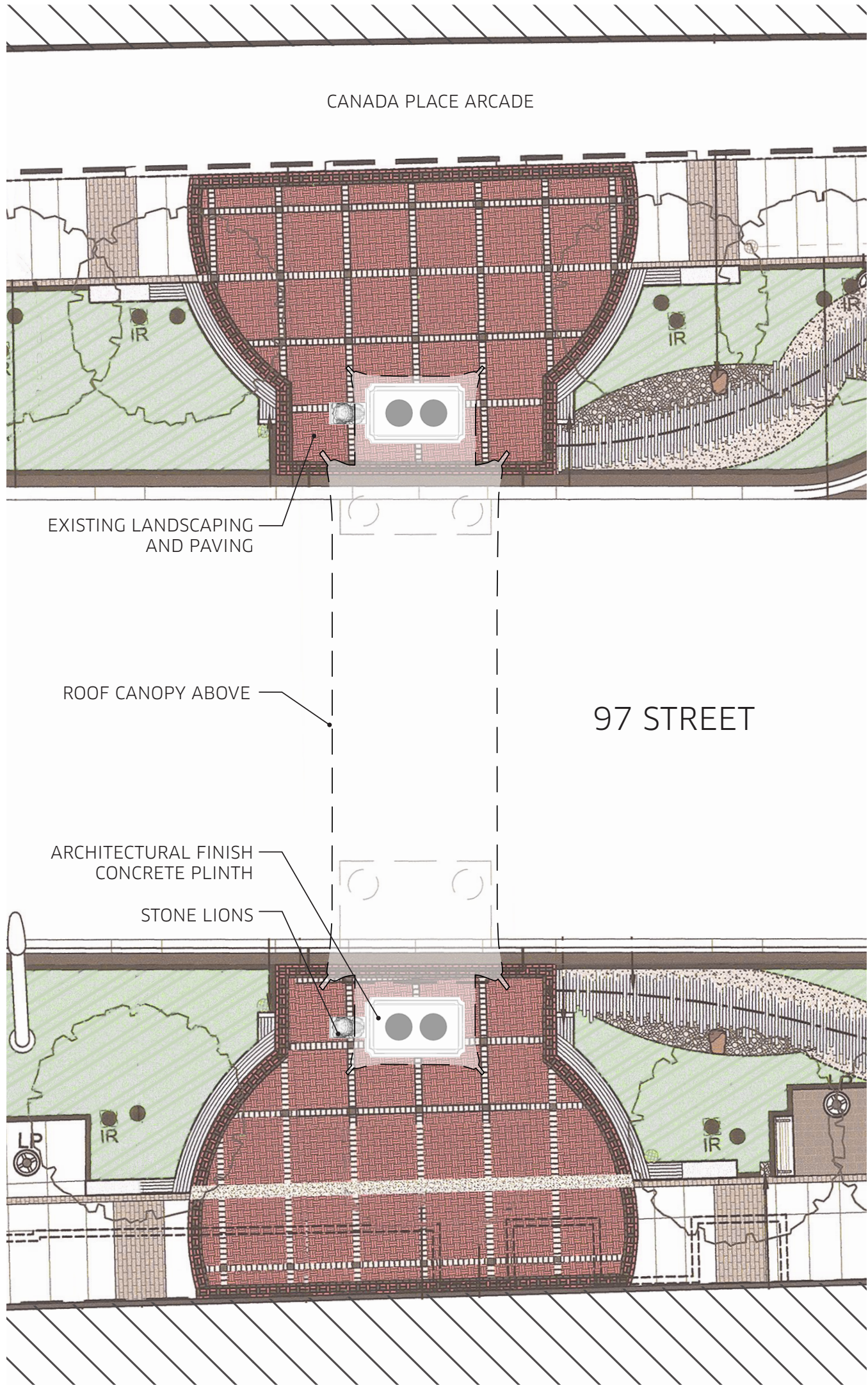

Paved plazas on either side of the gate welcomes pedestrians and ties the gate into the surrounding streetcape



Updated streetscape along 97 St.

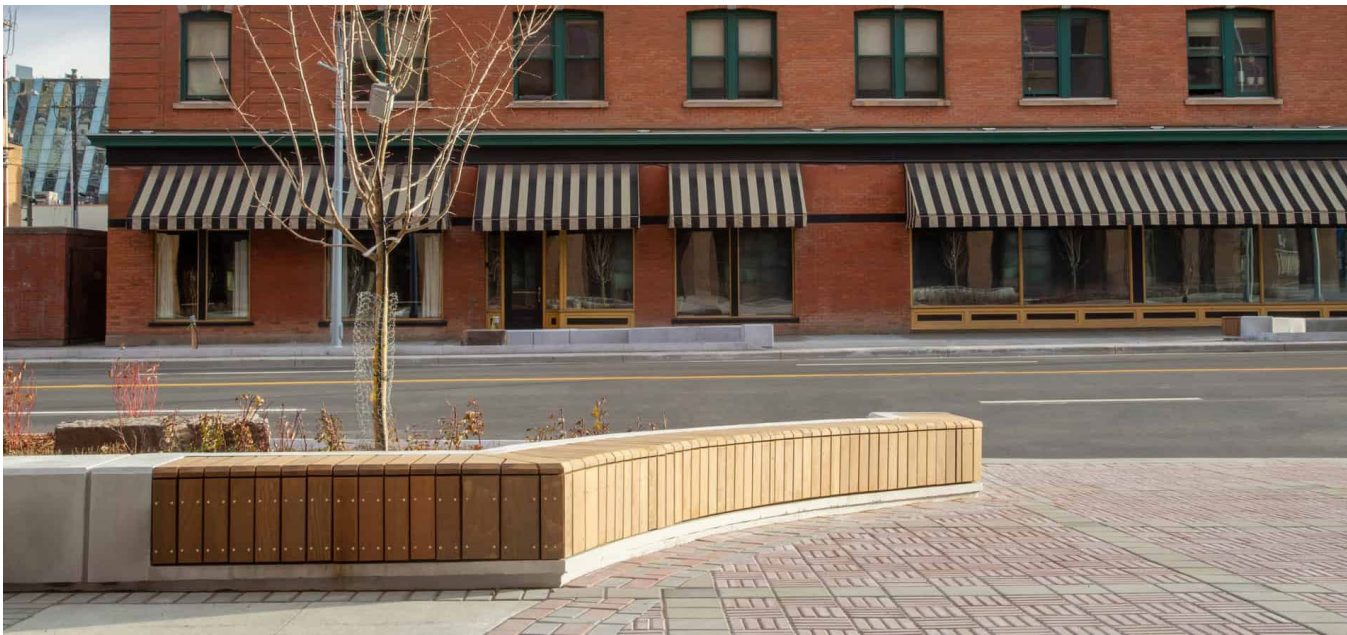

Street furniture incorporated into plaza design

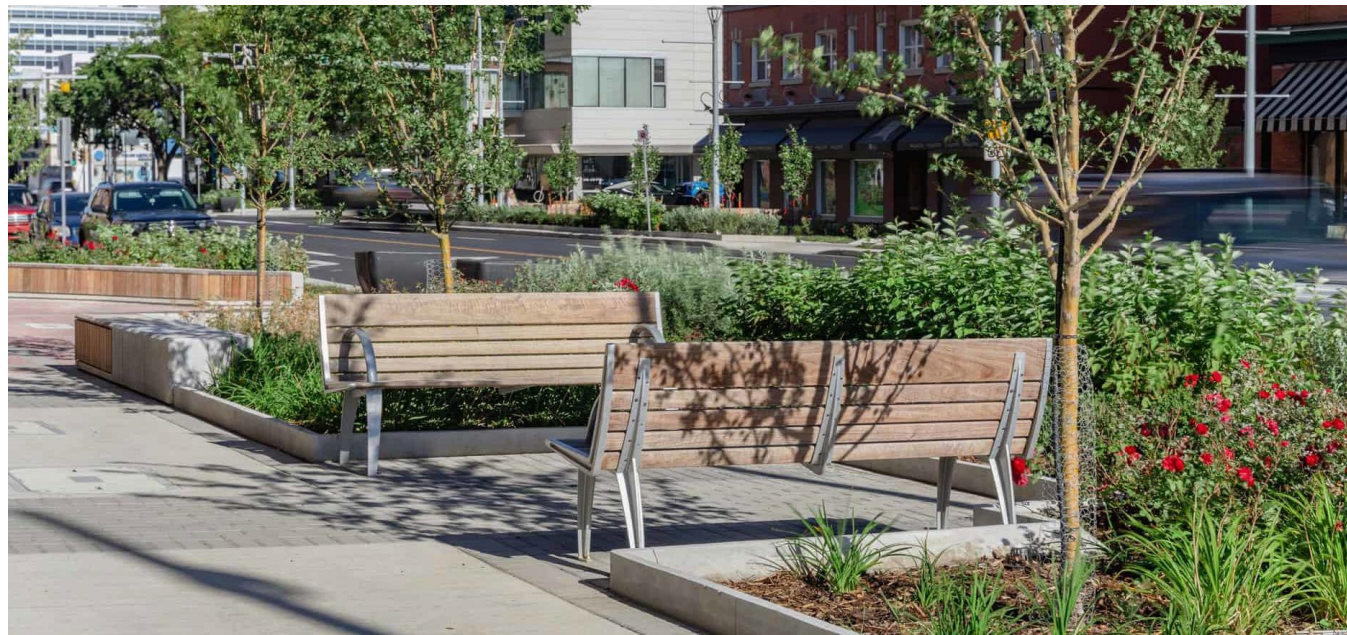

Rest areas incorporated into landscaping



The east and west plazas are part of the pedestrian gateway experience.



Potential public art collaborations on the columns and plinths

Materials

Materials have been selected for durability and ease of maintenance, as well as suitability for Edmonton’s climate.



1 - ROOFING TILE

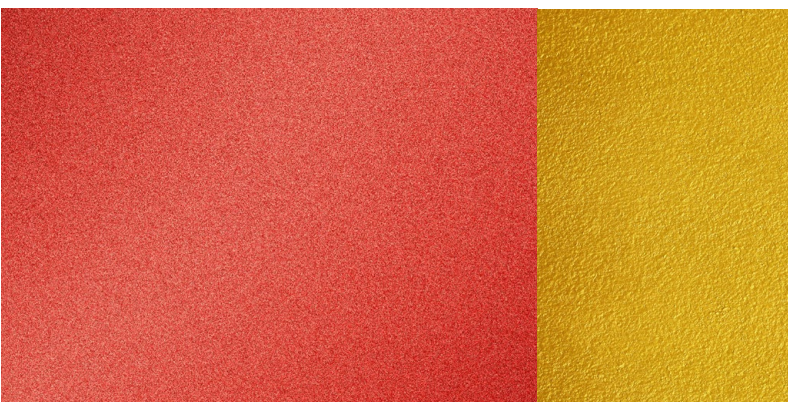

2 - POLYURETHANE COATED STEEL

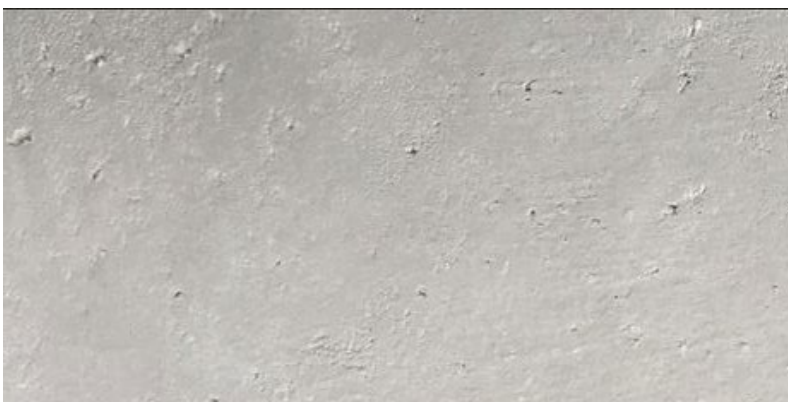

3 - ARCHITECTURAL FINISH CONCRETE



4 - SILKSCREEN GLAZED PANELS



5 - DECORATIVE TILES